

# DM298GRID

## Wiring instructions

### Installation

1. Isolate mains supply.
2. Refer to the grid assembly instructions below to fit the appropriate grid adaptor, and clip the adaptor into the grid.
3. Connect the dimmer to the mains supply, 220 - 240V AC, 50Hz. See below for wiring examples.
4. Secure the face plate to the back box.

### Wiring examples

#### 1 way

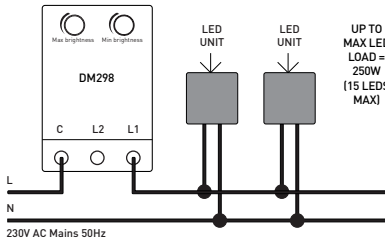

#### 2 way with 2 way switch

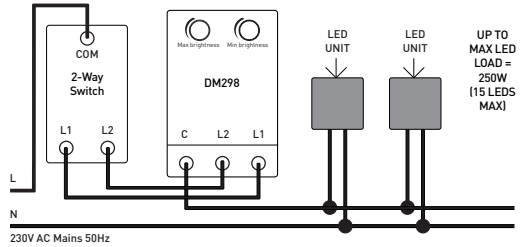

Grid Plates with 2 or more dimmers must be de-rated

Number of dimmer switches per plate	Nominal plate size (mm)	MAX loading per dimmer (Max 15 LEDs per circuit)
1	86 x 86	250VA
2	86 x 86	210VA
3	86 x 146	175VA
4	86 x 146	135VA

### Grid assembly

1. Remove the knob and security nut.

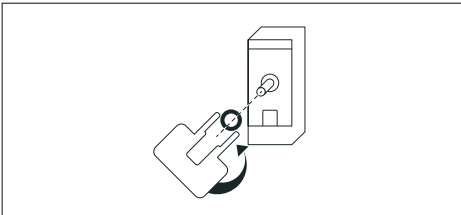

2. Choose the appropriate adaptor to fit your grid.

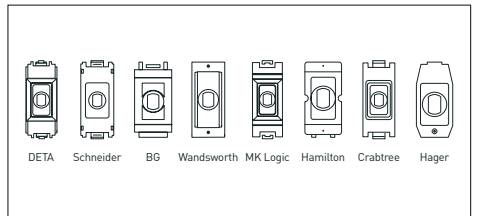

EN t +44 (0) 1604 495 151 f +44 (0) 1604 495 095 e sales@collingwoodgroup.com w collingwoodlighting.com  
Collingwood Lighting, Brooklands House, Sywell Aerodrome, Sywell, Northampton NN6 0BT, United Kingdom

FR t +33 (0) 4 816 816 10 f +33 (0) 4 816 816 11 e ventes@collingwoodgroup.com w collingwoodlighting.com  
Collingwood Lighting Limited, 43-47 Avenue de la Grande Armée, 75 116, Paris, France

# DM298GRID

## Wiring instructions

3. Fit the adaptor and secure with the nut.

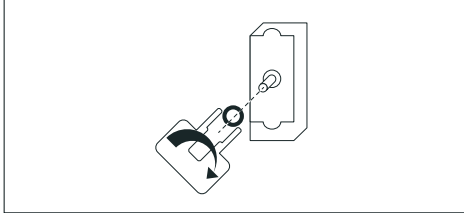

4. Replace the knob and fit the dimmer into grid plate.

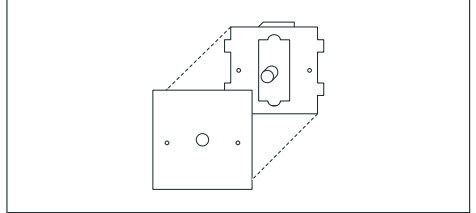

### Installation data

- Isolate the mains supply, prior to wiring.
- This unit must be wired by a qualified electrician or suitable competent person.
- Indoor use only.
- Suitable for dimmable LED lights.
- Input Voltage: 220-240V AC 50Hz
- Minimum load: 5VA
- Maximum load: 250VA (max 15 units)

### Set minimum and maximum brightness

- To adjust the minimum and maximum brightness use two potentiometers at the back of the dimmer.

**Note:** If flickering is noticed at the minimum level, slightly increase the minimum brightness setting.



Disposal of this product should be separate from household waste. Please separate these items from other types of waste and recycle them responsibly to promote the sustainable reuse of material resource. Household users should contact their local government office for details of where and how they can take these items for environmentally safe recycling.

**EN** t +44 (0) 1604 495 151 f +44 (0) 1604 495 095 e sales@collingwoodgroup.com w collingwoodlighting.com  
Collingwood Lighting, Brooklands House, Sywell Aerodrome, Sywell, Northampton NN6 0BT, United Kingdom

**FR** t +33 (0) 4 816 816 10 f +33 (0) 4 816 816 11 e ventes@collingwoodgroup.com w collingwoodlighting.com  
Collingwood Lighting Limited, 43-47 Avenue de la Grande Armée, 75 116, Paris, France