

**PERFECT FOR NEW CEILING INSTALLATIONS
& UNDER CABINET LIGHTING**

Eterna[®]
Everyday Lighting For Professionals

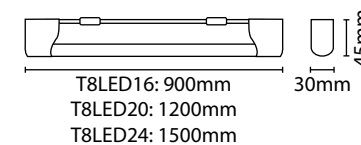

T8LED20

LED BATTENS

- Polycarbonate and aluminium construction
- Low energy alternative to a standard fluorescent batten
- Ultra-bright LEDs: low power consumption with enhanced life expectancy
- Slim design: offers a more stylish and modern solution to traditional battens
- Snap in fixing clips: easy installation
- 4000K colour temperature: for neutral white appearance
- Up to 87.5 lm / W
- 5 year warranty

• M.O.M: 1 / O.P.Q: 20

Code	Length	Colour	Wattage	Colour Temp.	Lumens	Avg. Rated Life (Hrs)	IP Rating	Lumen Efficacy
T8LED16	900mm / 3ft	Matt Silver / White	16W	4000K	1280 lm	20,000 hrs	IP20	80 lm / W
T8LED20	1200mm / 4ft		20W		1600 lm			80 lm / W
T8LED24	1500mm / 5ft		24W		2100 lm			87.5 lm / W

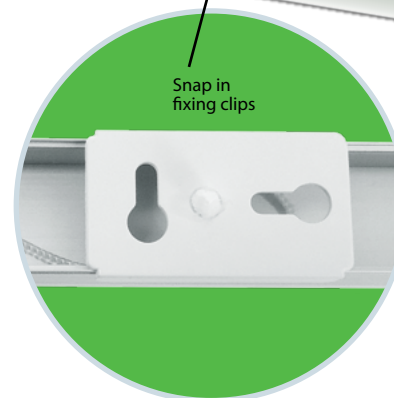
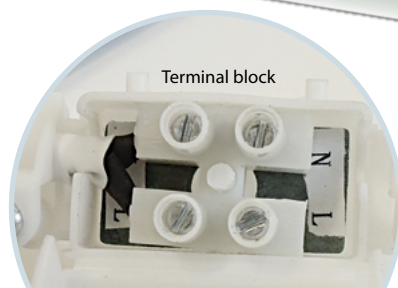

LAMP SPECIFICATIONS:	T8LED16	T8LED20	T8LED24
Lumens total flux	1280 lm	1600 lm	2100 lm
Rated Wattage	16W	20W	24W
Rated luminous flux	1280 lm	1600 lm	2100 lm
Nominal life time of the lamp	20,000 hrs	20,000 hrs	20,000 hrs
Colour temperature	4000K	4000K	4000K
Number of switching cycles before premature lamp failure	≥15,000	≥15,000	≥15,000
Warm-up time up to 60 % of the full light output	Instant full light	Instant full light	Instant full light
Dimmable	No	No	No
Lamp dimensions (L)	900mm	1200mm	1500mm
Rated power	16W	20W	24W
Rated lamp lifetime	20,000 hrs	20,000 hrs	20,000 hrs
Lamp power factor	0.85	0.85	0.85
Lumen maintenance factor at end of nominal life	>70%	>70%	>70%
Starting time	Instant full light	Instant full light	Instant full light
Colour rendering	>80	>80	>80
Colour consistency	Within 6 step Macadam ellipse	Within 6 step Macadam ellipse	Within 6 step Macadam ellipse
Rated beam angle	180°	180°	180°
Voltage	240V	240V	240V