

TUBULAR HEATERS AND GUARDS



TUBULAR HEATER

- Steel construction
- Thermal overload cut out
- Pre-wired with 1m mains lead: easy installation
- Additional locking cable gland included for through wiring / linking to other tubular heaters
- Mounting brackets included for wall or floor installation
- Low wattage solution for localised background heat and frost protection

TUBULAR HEATER GUARD

- Steel construction
- Robustly constructed wire guard: provides protection and safety
- Colour matches tubular heater
- Aesthetically pleasing curved design
- Fixing kit included

- **TH1** = M.O.M: 1 / O.P.Q: 20
- **TH2** = M.O.M: 1 / O.P.Q: 12
- **TH3** = M.O.M: 1 / O.P.Q: 9
- **TH4** = M.O.M: 1 / O.P.Q: 6
- **TRG1FT** = M.O.M: 2 / O.P.Q: 18
- **TRG2FT** = M.O.M: 2 / O.P.Q: 12
- **TRG3FT** = M.O.M: 2 / O.P.Q: 6
- **TRG4FT** = M.O.M: 2 / O.P.Q: 6

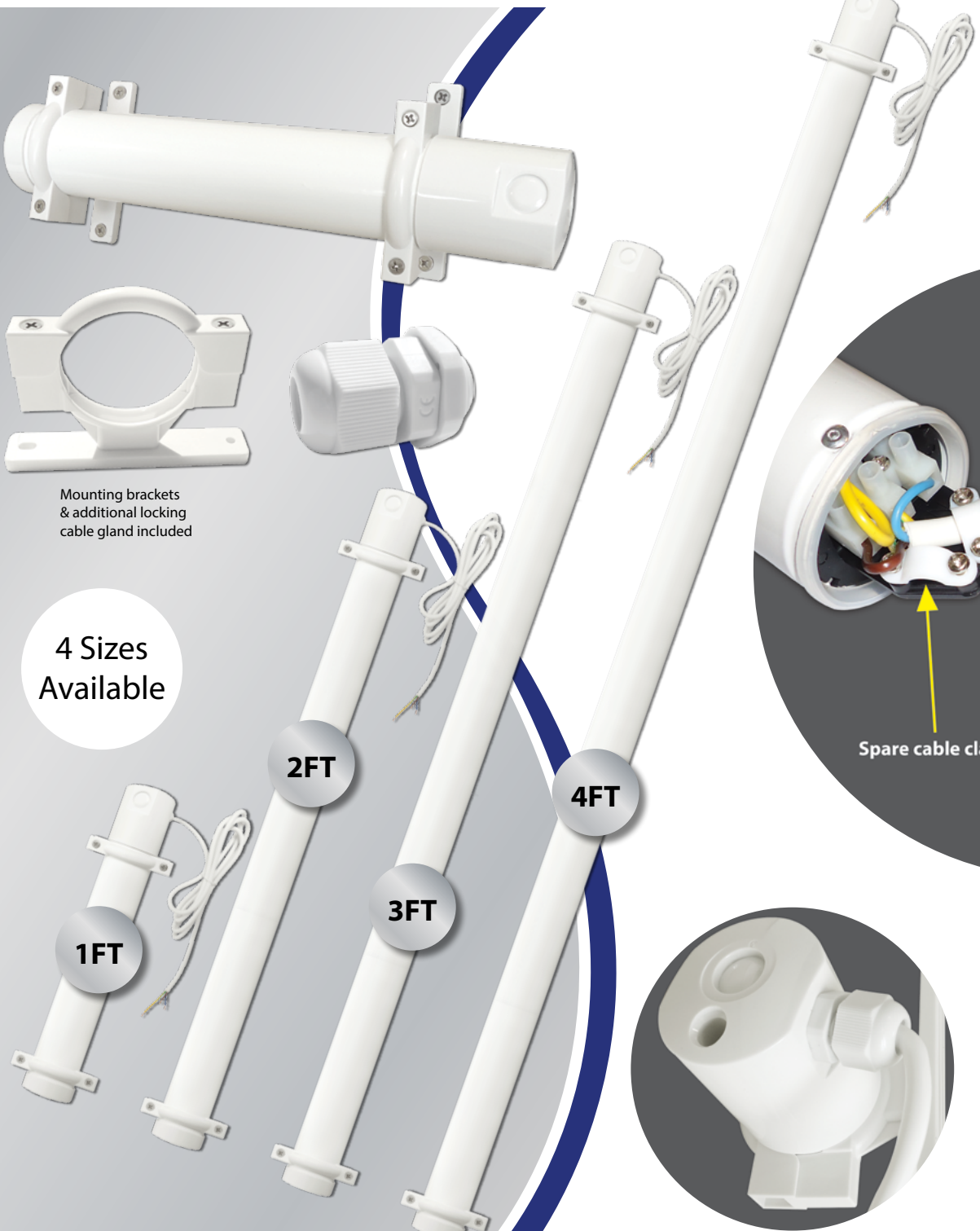

Mounting brackets & additional locking cable gland included

4 Sizes Available

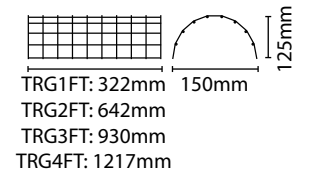
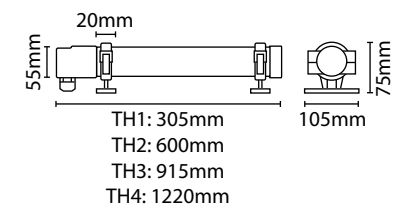

Code	Version	Colour	Wattage	IP Rating
TH1	1 Ft Heater	White	60W	IP44
TH2	2 Ft Heater		120W	
TH3	3 Ft Heater		180W	
TH4	4 Ft Heater		240W	

Code	Version	Colour
TRG1FT	1 Ft Guard	White
TRG2FT	2 Ft Guard	
TRG3FT	3 Ft Guard	
TRG4FT	4 Ft Guard	

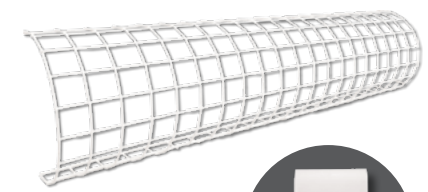

Fixing clips included