

## OIL FILLED RADIATOR



### Specifications

**Rated Voltage Range:** AC220-240V 50Hz

**7 Fin Oil Filled Radiator 1500W**

**3 heating powers:** 600W/900W/1500W

**9 Fin Oil Filled Radiator 2000W**

**3 heating powers:** 800W/1200W/2000W

**11 Fin Oil Filled Radiator 2500W**

**3 heating powers:** 1000W/1500W/2500W

## **WARNING: PLEASE READ THIS INSTRUCTION MANUAL CAREFULLY BEFORE USE**

For household use only. When using an electrical appliance, basic safety precautions should always be observed, including the following:

- 1) This appliance is not intended for use by persons (including children) with reduced physical, sensory or mental capabilities, or lack of experience and knowledge, unless they have been given supervision or instruction concerning use of the appliance by a person responsible for their safety.
- 2) Children should be supervised to ensure that they do not play with the appliance.
- 3) Connect the appliance to a single phase AC supply of the voltage specified on the rating plate.
- 4) In order to avoid overheating, do not cover the heater.
- 5) Never leave the heater unattended while it is in use. Always turn the product to the OFF position and unplug it from the electrical outlet when not in use.
- 6) Extreme caution is necessary when any heater is used by or around children, invalids or elderly people and whenever the heater is left operating and unattended.
- 7) The heater must not be placed immediately below an electrical socket-outlet.
- 8) Do not run the power cord under carpeting and do not cover the cord with throw rugs, runners or similar. Arrange the cord away from traffic areas and where it will not be tripped over.
- 9) Do not operate the heater with a damaged cord or plug, or after the heater malfunctions, has been dropped, or damaged in any manner.
- 10) If the supply cord is damaged, it must be replaced by the manufacturer, the service agent or a similarly qualified person to avoid a hazard.
- 11) Avoid the use of an extension cord as this may overheat and cause a risk of fire.
- 12) Use the heater in a well-ventilated area. Do not insert or allow objects to enter any ventilation or exhaust opening. To prevent a possible fire, do not block air intakes or exhaust openings in any manner. Do not use on soft surfaces e.g a bed, where openings may become blocked. Use the heater on flat, dry, even surface only.
- 13) Do not place this heater near flammable materials, surfaces or substances, as there may be a risk of fire. Keep any flammable materials, surfaces or substances at least 1m from the front of the product and keep them away from the sides and rear.
- 14) Do not use the heater in any areas where petrol, paint or other flammable liquids are stored e.g. garages or workshops as hot, arcing or sparking parts are inside the heater.
- 15) Do not use this heater in the immediate surroundings of a bath, shower or a swimming pool. Never place the heater where it may fall into a bathtub or in other water containers.
- 16) This heater is hot when in use. To avoid burns and personal injury, do not let bare skin touch hot surfaces. If provided, use handles when moving the product.
- 17) Be sure that no other appliances are in use on the same electrical circuit as your product as an overload could occur.
- 18) This heater is filled with a precise quantity of special oil.
- 19) Repairs requiring opening of the oil container are only to be made by the manufacturer or the service agent who should be contacted if there is an oil leakage.
- 20) Regulations concerning the disposal of oil when scrapping the appliance have to be followed.
- 21) The heater should not be used in a room of which the floor area is less than 5m<sup>2</sup>.
- 22) The cord should not be placed near the hot surface of the appliance.
- 23) NOTE: It is normal that when the heaters are turned on for the first time or when they are turned on after having not been used for a long period of time they may have noise inside. This will disappear when the heater has been on a short while.

## OS0FR15 / OS0FR20 / OS0FR25 Series



### Assembly Instructions

The heater is packaged with the feet unattached. You must attach them before operating the heater.

**WARNING: Do not operate without feet attached. Operate the heater only in an upright position (feet on the bottom, controls on the top), any other position could create a hazardous situation.**

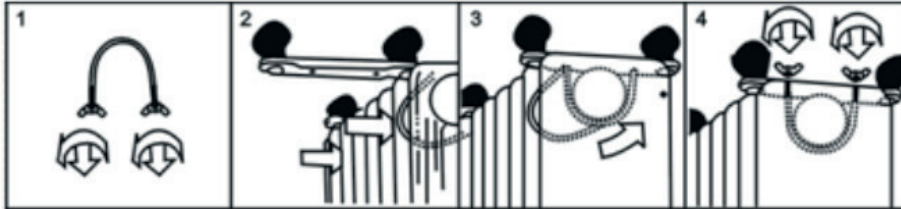

- 1) Place the radiator body upside-down on a scratch-free location making sure it is stable and will not fall over.
- 2) Screw off the wing nuts from the U-shaped bolt provided, attach the U-shaped bolt to the U-facing flange between first and second fins (near the front cover).
- 3) To attach the castor mounting plate to the radiator body you should insert the threaded ends of the U-shaped bolt in the holes on the castor mounting plate.
- 4) Screw the wing nuts back to the U-shaped bolt and fasten the wing nut properly.

**Note: do not over tighten as this may cause damage to the radiator flange.**

- 5) Screw off the spherical nut from the castor, align the shaft to the hole of the castor mounting plate, insert in, and screw on the spherical nut.
- 6) Repeat 2, 3, 4 and 5 on the rear of radiator for mounting of the rear castors.

**Note: the rear castors must be mounted between the end two fins.**

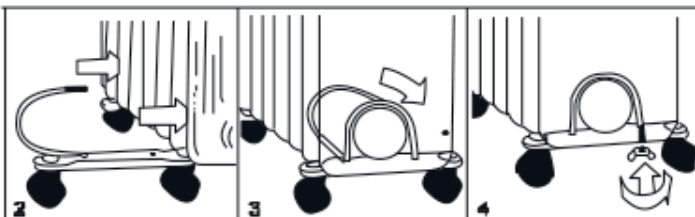

## Instructions For Use

- 1) Before using the heater make sure that it is on a flat and stable surface. Damage may occur if it is placed on an incline or decline.
- 2) Set all the controls to the OFF position and insert the plug into a socket-outlet. Be sure that the plug fits firmly.
- 3) Rotate the thermostat knob clockwise to MAX position and switch the heater on as follow: switch I for low heat, switch II for medium heat and both switches on for high heat.
- 4) When your room reaches the desired temperature, slowly rotate the thermostat knob anti-clockwise until the pilot light goes out. The thermostat can now be left at this setting. As soon as the room temperature has dropped below the set temperature, the unit will switch on automatically until the set temperature has been reached again. In this way the room temperature remains constant with the most economical use of electricity.
- 5) If you want to change the room temperature setting, rotate the thermostat knob clockwise to raise the temperature, or anti-clockwise to lower it.
- 6) This heater includes an overheat protection system which will shuts off the heater when parts of the heater are getting excessively hot.
- 7) To completely shut the heater off turn all the controls to OFF and remove the plug from the socket-outlet.

## Maintenance

- 1) Always remove the plug from the socket-outlet and allow the radiator to cool down before cleaning the heater.
- 2) To clean the radiator wipe with a soft, damp cloth.

### WARNING:

**Do not immerse the heater in water.**

**Do not use any cleaning chemicals such as detergents and abrasives.**

**Do not allow the interior to get wet as this could create a hazard.**

- 3) To store the heater, wind the cable around the bobbin and place in a clean, dry area.
- 4) In case of malfunction or doubt do not try to repair the radiator yourself as it may result in a fire hazard or electric shock.

## Conformity With Directives

This product is CE marked to denote conformity with Directives 2006/95/EC (Low Voltage) and the EMC directive (2004/108/EC), as amended.

## Environment



This marking indicates that this product should not be disposed with other household wastes throughout the EU. To prevent possible harm to the environment or human health from uncontrolled waste disposal, recycle it responsibly to promote the sustainable reuse of material resources. To return your used device, please use the return and collection systems or contact the retailer where the product was purchased. They can take this product for environmental safe recycling.