

## LED Panel Installation Instructions



**Please read these instructions carefully before installation**  
Leave a copy for the user/maintenance engineer for future reference

### Important Safety Information

- It is recommended that this fitting is installed, inspected and maintained by a qualified Electrician.
- Installation should be carried out in accordance with the latest edition of the IEE Wiring Regulations (BS 7671) and the latest Building Regulations. If in doubt, consult a qualified electrician.
- These products are designed for connection to a 220-240V~50/60Hz supply.
- Before commencing any installation or maintenance work, ensure electricity is disconnected / isolated.
- Important: Ensure that ALL electrical connections are tight with no loose strands including factory made connections.
- Please note the IP rating of this luminaire when deciding the location for installation.
- This luminaire is suitable for indoor use only.
- This product is non-dimmable.
- This is a class II luminaire, double insulated, no earth required.
- The LED lamps fitted in this product are non-replaceable, the whole luminaire must be replaced when the LED reaches the end of its life.

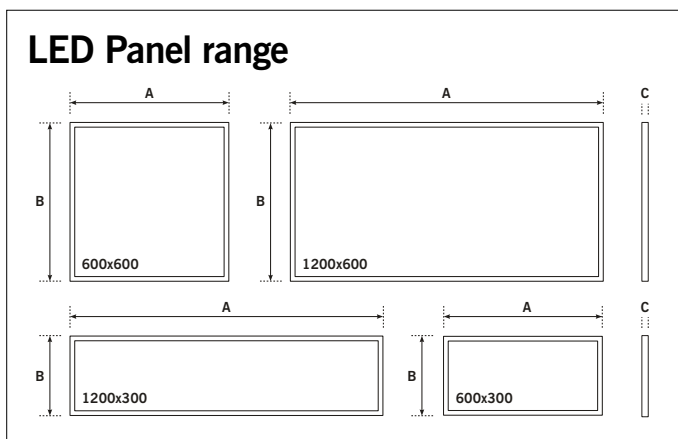

### Accessories\*

Part No.	Description	Use with Product
LXPAN63SMB	Surface Mount Box	600x300
LXPAN66SMB	Surface Mount Box	600x600
LXPAN123SMB	Surface Mount Box	1200x300
LXPAN126SMB	Surface Mount Box	1200x600
LXPAN663SCK	Suspension Cable Kit	600x300 & 600x600
LXPAN1263SCK	Suspension Cable Kit	1200x300 & 1200x600
<b>Emergency</b>	Remote Emergency Pack - Available on request	
<b>Dimmable</b>	1-10V/Dali Dim Driver - Available on request	

### Technical Specifications

Part No.	Description	Power (W)	Measurement (AxBxC mm)	Lumen Output	IP Rating	Power Factor	CRI	Colour Temperature
LXPAN28LED63NW2	LED Recessed Panel	28	595 X 295 X 10.5	2240	IP20	> 0.90	> 0.80	4000K
LXPAN28LED63CW2	LED Recessed Panel	28	595 X 295 X 10.5	2240	IP20	> 0.90	> 0.80	6000K
LXPAN30LED66WW2	LED Recessed Panel	30	595 X 595 X 10.5	3000	IP20	> 0.90	> 0.80	3000K
LXPAN30LED66NW2	LED Recessed Panel	30	595 X 595 X 10.5	3000	IP20	> 0.90	> 0.80	4000K
LXPAN30LED66CW2	LED Recessed Panel	30	595 X 595 X 10.5	3000	IP20	> 0.90	> 0.80	6000K
LXPAN30LED66NW2/IP54	LED Recessed Panel/IP54	30	595 X 595 X 13.5	3000	IP54	> 0.90	> 0.80	4000K
LXPAN33LED66NW2/UGR19	LED Recessed Panel/UGR<19	33	595 X 595 X 10.5	3300	IP20	> 0.90	> 0.80	4000K
LXPAN36LED66WW2	LED Recessed Panel	36	595 X 595 X 10.5	3000	IP20	> 0.90	> 0.80	3000K
LXPAN36LED66NW2	LED Recessed Panel	36	595 X 595 X 10.5	3100	IP20	> 0.90	> 0.80	4000K
LXPAN36LED66CW2	LED Recessed Panel	36	595 X 595 X 10.5	3100	IP20	> 0.90	> 0.80	6000K
LXPAN60LED123NW2	LED Recessed Panel	60	1195 X 295 X 10.5	5100	IP20	> 0.90	> 0.80	4000K
LXPAN60LED123CW2	LED Recessed Panel	60	1195 X 295 X 10.5	5100	IP20	> 0.90	> 0.80	6000K
LXPAN60LED126NW2	LED Recessed Panel	60	1195 X 595 X 10.5	5100	IP20	> 0.90	> 0.80	4000K
LXPAN60LED126CW2	LED Recessed Panel	60	1195 X 595 X 10.5	5100	IP20	> 0.90	> 0.80	6000K

## Important Installation Information

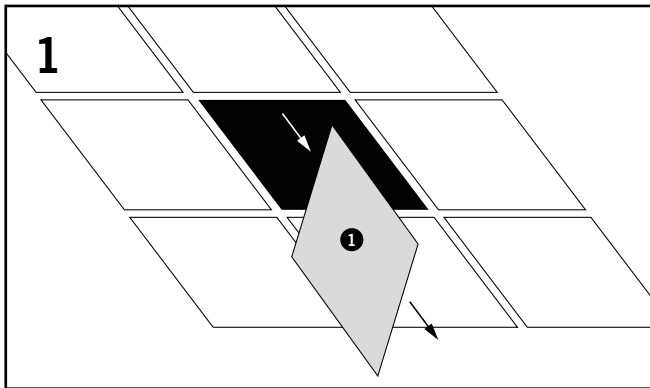

1 - Ceiling tile

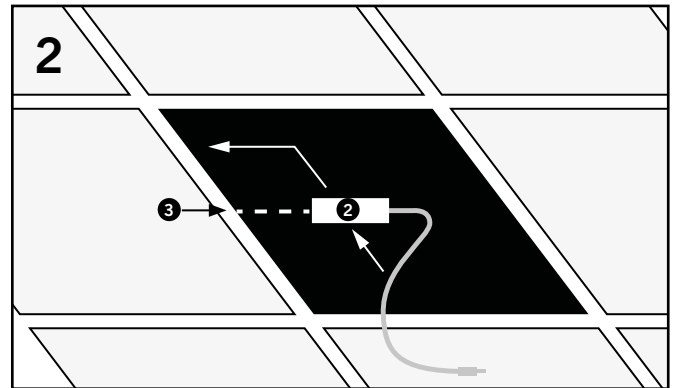

2 - LED driver

3 - Mains supply

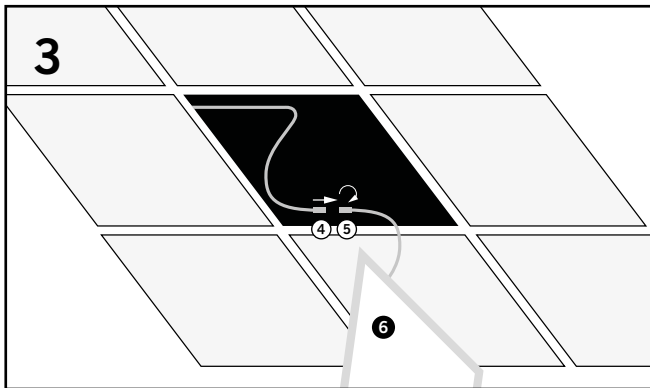

4 - Driver plug lead

5 - Panel plug lead

6 - LED panel

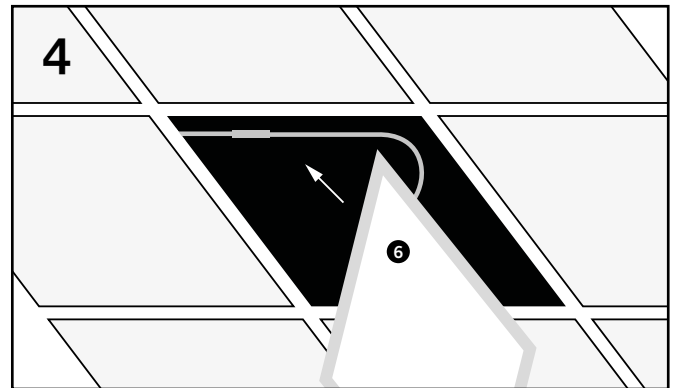

6 - LED panel

- Always switch off the mains power supply before installation or servicing.
- The LUXNA LED Panel range is suitable to fit 15mm and 25mm exposed T bar ceiling grids.
- Ensure that the mounting area is clean and free from any obstructions. The installation must not infringe on gas/water pipes or any other electrical cables or services which may be hidden behind the ceiling.

1). When installing into a suspended ceiling grid, remove the relevant tile from the position where the LED Panel is to be located.

2). Locate the LED driver which is supplied with the luminaire into the open ceiling void and connect the mains supply to the input terminals of the driver.

3). Connect the driver plug lead which is pre-wired into the output terminals of the LED driver to the panel plug lead which is attached to the LED Panel. Rotate the two plugs 90 degrees to ensure a secure connection.

4). Place the LED Panel into the open ceiling void and locate the panel frame onto the exposed T bar grid.

- When the LUXNA LED Panel is connected and installed, turn on the mains power supply and check for correct operation.
- \* Optional accessories are available for surface and wire suspension mounting. Please refer to the website for further details and installation information.
- \* Remote emergency pack and Dimmable driver options are also available to suit the installation requirements.

### Warranty

This product is guaranteed in the EU for a period of 5 years from the date of purchase. The guarantee is invalid in the case of improper use, installation, tampering, removal of the QC/batch code label, installation in an improper working environment or installation not according to the current edition of the IEE Wiring Regulations (BS 7671). Should this product fail during the guarantee period it will be replaced free of charge, subject to correct installation and return of the faulty unit. Luxna Lighting does not accept responsibility for any installation costs associated with the replacement of this product. Your statutory rights are not affected. Luxna Lighting reserves the right to alter product specifications without prior notification.