

LED Wall Pack, Slim Installation Instructions



Please read these instructions carefully before installation
Leave a copy for the user/maintenance engineer for future reference

Important Safety Information

- It is recommended that this fitting is installed, inspected and maintained by a qualified Electrician.
- Installation should be carried out in accordance with the latest edition of the IET Wiring Regulations (BS 7671) and the latest Building Regulations. If in doubt, consult a qualified electrician.
- This product is designed for connection to a 220 -240V~50/60Hz mains supply.
- Before commencing any installation or maintenance work, ensure electricity is disconnected / isolated.
- Ensure that all electrical connections are tight with no loose strands including factory made connections.
- This luminaire is suitable for indoor and outdoor use.
- Please note the IP rating of this luminaire when deciding the location for installation.
- This product is non-dimmable.
- This is a class II construction luminaire, no earth required.
- This luminaire is suitable for use in ambient area temperatures of -10 °C to +40 °C (Standard Luminaire) 0°C to +40°C (Emergency Luminaire)
- The luminaire body and diffuser are made from Polycarbonate material. Always ensure that the product is suitable for the intended installation area
- Do not carry out insulation resistance tests with the luminaire connected to the circuit.
- MCBs may require to be updated to allow for increased inrush current.
- This product contains a light source of energy efficiency class D.
- The Light Source and Control Gear contained in this luminaire shall only be replaced by the manufacturer or his service agent or similar qualified professional person.

LED Wall Pack, Slim Range

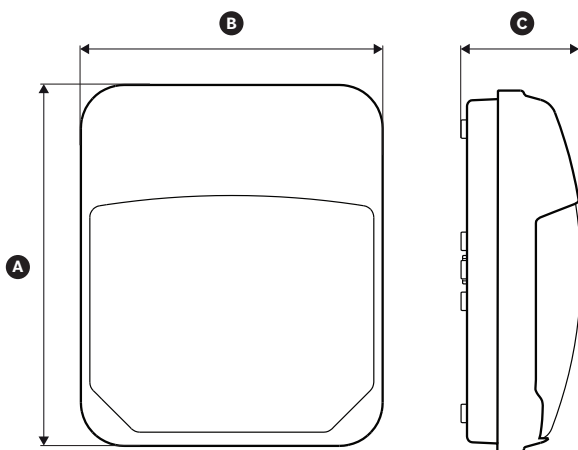

Photocell Version

Photocell is pre-installed in the side housing of the luminaire

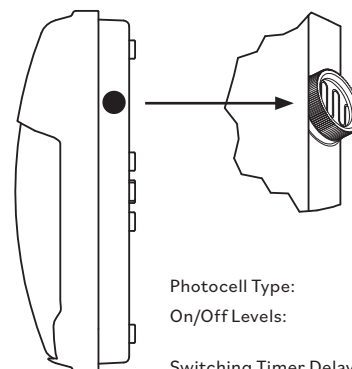

Photocell Type: Button Control
On/Off Levels: 10~20Lux On
30~60Lux Off
Switching Timer Delay: 0~120s

Technical Specifications

Part No.	Description	Photocell	Emergency EM3	Wattage	Measurement A x B x C	Lumen Output	IP Rating	Power Factor	CRI Ra	Colour Temperature
LXWPS	LED Wall Pack, Slim	No	No	22W	305 x 255 x 101mm	1500Lm	IP65	> 0.90	> 80	4000K
LXWPS/PC	LED Wall Pack, Slim	Yes	No	22W	305 x 255 x 101mm	1500Lm	IP65	> 0.90	> 80	4000K
LXWPS/EM3	LED Wall Pack, Slim	No	Yes	22W	305 x 255 x 101mm	1500Lm	IP65	> 0.90	> 80	4000K
LXWPS/EM3/PC	LED Wall Pack, Slim	Yes	Yes	22W	305 x 255 x 101mm	1500Lm	IP65	> 0.90	> 80	4000K

Important Installation Information

Select a suitable mounting position and use the correct fixings for the type of surface. Ensure that there is adequate free air ventilation around the luminaire at all times. Do not install this product onto damp or newly plastered surfaces. Isolate the mains power supply before commencing installation.

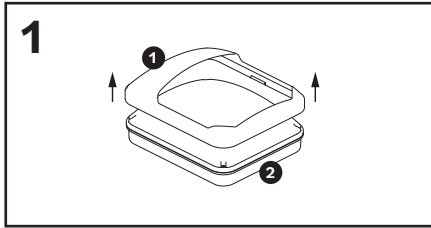

Remove the front trim **1** from the base **2**.

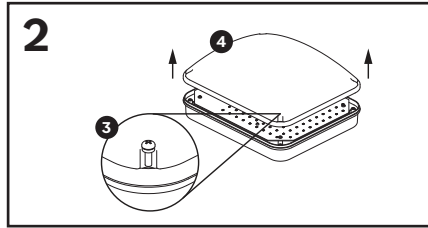

Unscrew the four diffuser fixing screws **3** and remove the front diffuser **4**.

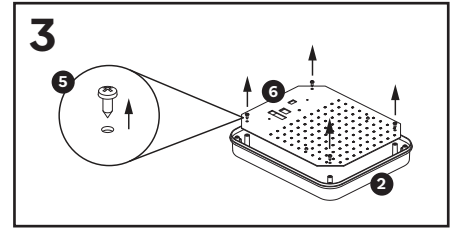

Unscrew the four retaining screws **5** and remove the SMD LED board **6** from the base **2**.

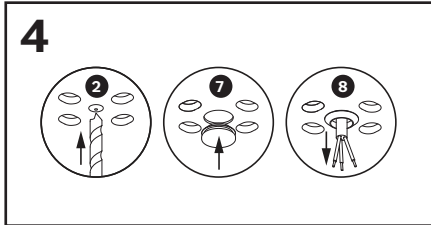

Drill out a hole in the base **2** for cable entry and fit the grommet provided **7**. Feed the mains supply cable **8** through the grommet. Drill holes, position and fix the base **2** to a suitable solid surface using the fixing screws provided.

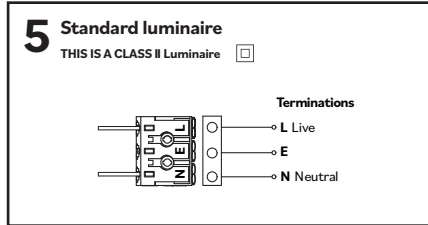

Terminate the mains supply cable **8** into the terminal block mounted on the underside of the SMD LED board ensuring that the correct polarity is observed. All conductors must be fully sleeved and insulated.

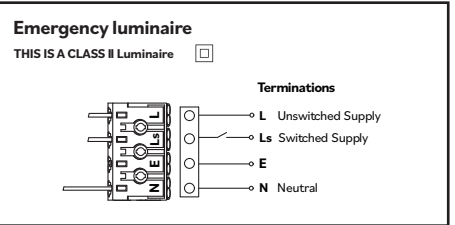

For Emergency luminaires – Ensure that the luminaire has a continuous live supply to **L** (Unswitched live). The "Maintained" emergency luminaire can be "switched" via connection **Ls** (Switched Supply). Ensure battery cells cable is connected.

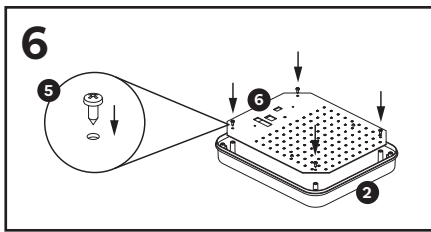

Dress any cables away from the edges of the base **2** and re-align the SMD LED board **6**. Refit the board using the four retaining screws **5**.

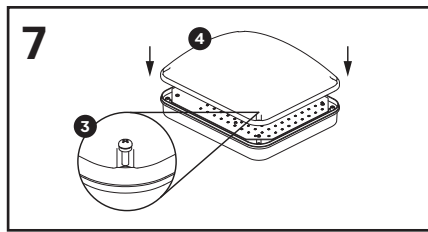

Re-fit the front diffuser **4** using the four diffuser fixing screws **3**.

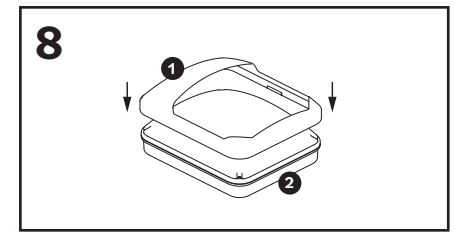

Refit the front trim **1** to the base **2**. Restore the mains power supply, switch on and test for satisfactory operation.

Emergency Luminaire Connection and Testing

1. The Emergency luminaire requires an unswitched live supply **L** in addition to the switched live supply **Ls**.
2. Ensure that the battery cells supply cable is connected to the Emergency module before mains power is restored.
3. Once installed, the batteries must be charged for a minimum of 24 hours before carrying out a full discharge and commissioning test to check that they are charging correctly and that the maintained 3-hour discharge duration is being achieved. The date should be noted on the battery.
4. The Green LED Indicates that the batteries are charging.
5. Emergency luminaires should be routinely inspected and tested in accordance with current **BS 5266** guidelines. Refer to **BS 5266 & BS EN 50172** for full Emergency Lighting requirements and testing procedures
6. A log report must be completed and kept for the periodic test procedure. A copy of the Emergency test record sheet is included with this product. Further copies can be requested at sales@luxna.co.uk
7. A completed copy of the Emergency test record sheet must accompany any product returned to the manufacturer.

Batteries

The battery cells inside an emergency product are a consumable replaceable item. The batteries have a normal operating designed service life of 4 years and must be replaced in a timely manner to ensure that the integrity of the emergency lighting system is maintained. The battery cells actual service life can be shortened by several variable factors including (but not limited to): Type of installation environment, Room temperature, Number of charge/discharge cycles, power supply interruptions etc. The product should be tested and maintained regularly according to the details within the instruction manual. Should the battery cells fail to provide the minimum rated discharge duration of 3 hours at any time during the products service life, they must be replaced.

Emergency luminaires must not be installed in areas where the ambient area temperature is above or below the recommended operating temperature range 0°C to +40°C

Warranty: This product is protected by guarantee in the UK and EU for a period of 5 years warranty from the date of purchase against any defects in materials or workmanship. Should this product fail during the warranty period it will be repaired or replaced with the same or equivalent product free of charge, subject to providing the original receipt/invoice or proof of the original date of purchase and return of the faulty unit. If in our sole discretion, we are unable to repair or replace a defective product, we will refund the purchase price of the product. The warranty is invalid if in our judgment the product fails due to incorrect installation not conforming to our product instructions or installation within an improper working environment. The warranty will not apply if the product fails due to damage in storage, shipment, accident or misuse. Modification to the product in any way or removal of the batch number will void the warranty. Luxna Lighting does not accept responsibility for any installation, labour or travel costs which may be associated with the replacement or return of any faulty products. Our maximum liability under the terms of this warranty is limited to the purchase price of the product. Your statutory rights are not affected. Luxna Lighting reserves the right to alter product specifications without prior notification. Terms and conditions are also subject to change without prior notice.