

Epoxy Coated Steel Enclosure

Specifications and Dimensions

It is the responsibility of the person installing the electrical equipment to ensure that the installation meets the requirements of the IET wiring regulations and is therefore 'fit for purpose'. Factors such as correct selection of components, cable sizing, protective devices and Earth bonding are all critical and should be checked prior to full testing and power-up. Any other regulations applicable to the equipment being installed such as the Machinery Directive and current health and safety legislation must also be adhered to. All connections (including factory made) must be checked for the correct tightness prior to commissioning of the electrical installation. All connections should be checked periodically to ensure correct tightness. DO NOT USE POWER TOOLS ON THESE PRODUCTS.

- Earth studs included
- IP66 to EN60 529 (when fitted and sealed)
- Top and bottom gland plates
- Fixing brackets available
- Galvanised back plate included
- Strong steel (powder epoxy coated)
- Body and door RAL7035 (textured finish)
- Mounting plate in galvanized zinc steel sheet
- Body and door manufactured in 1.2 to 1.5mm sheet steel
- Gland plate manufactured in 2.0mm to 2.5mm sheet steel
- Enclosure coated with standard cycle thermosetting epoxy polyester powder
- **Not recommended for outdoor applications**

For any further comments or assistance please contact:

eris-eu.com



Industrial

Epoxy Coated Steel Enclosure

Specifications and Dimensions

Portrait

Part No	Size (H x W x D)	External Dimensions (mm)			Fixing Holes (mm)		Internal Depth from Mounting Plate (mm)	Gland Plate (mm)		Mounting Plate (mm)		Other Information (GPTN = Gland Plate Top and Bottom)
		H1	W1	D1	H2	W2		H3	W3	H4	W4	
ERS302515	300 x 250 x 150mm	300	250	150	277	277	125	62	130	240	190	1 Lock, GPTB
ERS303015	300 x 300 x 150mm	300	300	150	277	277	125	62	180	240	240	1 Lock, GPTB
ERS303020	300 x 300 x 200mm	300	300	150	277	277	175	62	180	240	240	1 Lock, GPTB
ERS403015	400 x 300 x 150mm	400	300	150	377	277	125	62	180	340	240	1 Lock, GPTB
ERS403020	400 x 300 x 200mm	400	300	200	377	277	175	62	180	340	240	1 Lock, GPTB
ERS403025	400 x 300 x 250mm	400	300	250	377	277	225	62	180	340	240	1 Lock, GPTB
ERS404015	400 x 400 x 150mm	400	400	150	377	377	125	63	215	340	340	1 Lock, GPTB
ERS404020	400 x 400 x 200mm	400	400	200	377	377	175	62	215	340	340	1 Lock, GPTB
ERS504020	500 x 400 x 200mm	500	400	200	477	377	175	120	315	440	340	2 Lock, GPTB
ERS504025	500 x 400 x 250mm	500	400	250	477	377	225	120	315	440	340	2 Lock, GPTB
ERS505025	500 x 500 x 250mm	500	500	250	477	477	225	120	415	440	440	2 Lock, GPTB
ERS604020	600 x 400 x 200mm	600	400	200	577	377	175	120	315	540	340	2 Locks, GPTB
ERS604030	600 x 400 x 300mm	600	400	300	577	377	275	120	315	540	340	2 Locks, GPTB
ERS604040	600 x 400 x 400mm	600	400	400	577	377	375	120	315	540	340	2 Locks, GPTB
ERS605020	600 x 500 x 200mm	600	500	200	577	477	175	120	415	540	440	2 Locks, GPTB
ERS605025	600 x 500 x 250mm	600	500	250	577	477	225	120	415	540	440	2 Locks, GPTB
ERS605030	600 x 500 x 300mm	600	500	300	577	477	275	120	415	540	440	2 Locks, GPTB
ERS606020	600 x 600 x 200mm	600	600	200	577	577	175	120	415	540	540	2 Locks, GPTB
ERS606025	600 x 600 x 250mm	600	600	200	577	577	225	120	415	540	540	2 Locks, GPTB
ERS705020	700 x 500 x 200mm	700	500	200	677	477	175	120	415	640	440	2 Locks, GPTB
ERS705025	700 x 500 x 250mm	700	500	250	677	477	225	120	415	640	440	2 Locks, GPTB
ERS705030	700 x 500 x 300mm	700	500	300	677	477	275	120	415	640	440	2 Locks, GPTB
ERS804030	800 x 400 x 300mm	800	400	300	777	377	275	120	315	740	340	2 Locks, GLTB
ERS806020	800 x 600 x 200mm	800	600	200	777	577	175	120	415	740	540	2 Locks, GPTB
ERS806030	800 x 600 x 300mm	800	600	300	777	577	275	120	415	740	540	2 Locks, GPTB
ERS806040	800 x 600 x 400mm	800	600	400	777	577	375	120	415	740	540	2 Locks, GPTB
ERS1006030	1000 x 600 x 300mm	1000	600	300	977	577	275	120	415	940	540	2 Locks, GPTB

For any further comments or assistance please contact:

eris-eu.com



Industrial

Epoxy Coated Steel Enclosure

Specifications and Dimensions

Portrait

Part No	Size (H x W x D)	External Dimensions (mm)			Fixing Holes (mm)		Internal Depth from Mounting Plate (mm)	Gland Plate (mm)		Mounting Plate (mm)		Other Information (GPTN = Gland Plate Top and Bottom)
		H1	W1	D1	H2	W2		H3	W3	H4	W4	
ERS1008030	1000 x 800 x 300mm	1000	800	300	977	777	275	120	315	940	730	2 locks, 4 Gland Plates (2 top / 2 bottom)
ERS1008040	1000 x 800 x 400mm	1000	800	400	977	777	375	120	315	940	730	2 locks, 4 Gland Plates (2 top / 2 bottom)
ERS1206030	1200 x 600 x 300mm	1200	600	300	1177	577	275	120	315	1130	540	3 locks, 4 Gland Plates (2 top / 2 bottom)
ERS1208030	1200 x 800 x 300mm	1200	800	300	1177	777	275	120	315	1130	730	3 locks, 4 Gland Plates (2 top / 2 bottom)
ERS1208040	1200 x 800 x 400mm	1200	800	400	1177	777	375	120	315	1130	730	3 locks, 4 Gland Plates (2 top / 2 bottom)

Landscape

Part No	Size (H x W x D)	External Dimensions (mm)			Fixing Holes (mm)		Internal Depth from Mounting Plate (mm)	Gland Plate (mm)		Mounting Plate (mm)		Other Information (GPTN = Gland Plate Top and Bottom)
		H1	W1	D1	H2	W2		H3	W3	H4	W4	
ERS304020	300 x 400 x 200mm	300	400	200	277	377	175	120	315	240	340	1 Lock, GPTB
ERS405020	400 x 500 x 200mm	400	500	200	377	477	175	120	415	340	440	1 Lock, GPTB
ERS406020	400 x 600 x 200mm	400	600	200	377	577	175	120	415	340	540	1 Lock, GPTB
ERS406030	400 x 600 x 300mm	400	600	300	377	577	275	120	415	340	540	2 Locks, GPTB

For any further comments or assistance please contact:

eris-eu.com

Epoxy Coated Steel Enclosure

Specifications and Dimensions

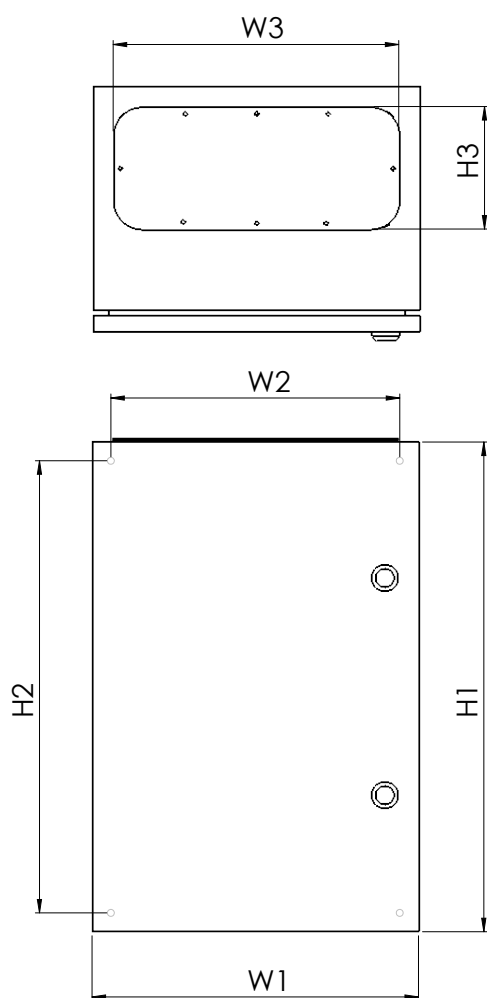

Dimension	Description
H1	External Dimensions
W1	
D1	
H2	Fixing Holes Dimensions
W2	
D2	Internal Depth from Mounting Plate
H3	Gland Plate Dimensions
W3	
H4	Mounting Plate Dimensions
W4	

Note: Fixing holes 8.5mm

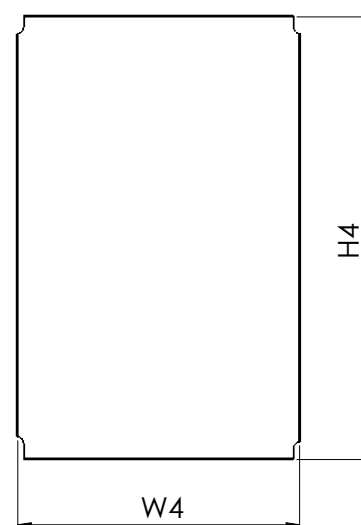

ERSKEYLOCK Dimensions:					
L1	L2	L3	B1	H1	φD
50mm	32.5mm	50mm	20mm	26.7mm	22mm

Key operated barrel lock also available



For any further comments or assistance please contact:

eris-eu.com