



BW Type Brass Cable Glands

For use with SWA, Plastic and Rubber (Elastomer) sheathed cables. Indoor and Outdoor whenever it is required to provide sealing on cable outer sheath.

BW glands are weatherproof glands and can be used in corrosive conditions when protected with shroud. Positive armour locking, effective earth continuity, increased mechanical strength.

Dimensions

- Metric: 20mm to 75mm (S/L)
- Imperial: 3/4" to 3" (S/L)

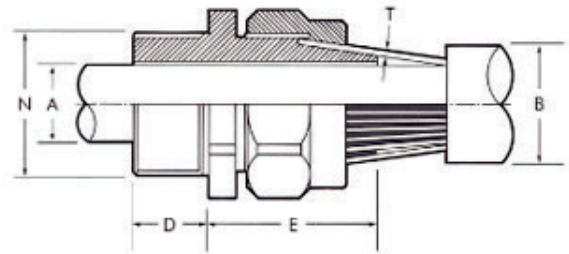
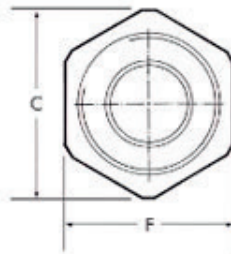

BW Gland Size	Mounting Thread		Cable Dimensions		Product Description	Product Description
	Dia mm	Length mm	A (max)	B (max)		
16/20	16/20	10	8.7	13.2	0.9	25
20s	20	10	11.6	16.8	0.90 - 1.25	28.5
20	20	10	13.9	20.8	0.90 - 1.25	34.5
25s	25	10	17.3	24	1.25 - 1.60	36
25	25	10	19.9	27	1.25 - 1.60	40
32	32	10	26.3	33	1.60 - 2.00	48.5
40s	40	15	30.2	37.8	1.60 - 2.00	56
40	40	15	32.2	41	1.60 - 2.00	58.5
50s	50	15	39.8	47	2.00 - 2.50	68
50	50	15	44	52.2	2.00 - 2.50	72.5
63s	63	15	50	60.3	2.00 - 2.50	82
63	63	15	55.8	66	2.00 - 2.50	88
75s	75	15	62.2	72	2.50 - 3.20	98
75	75	15	67.8	78	2.50 - 3.20	107.5
88/90	88/90	15	80	90	2.50 - 3.20	124