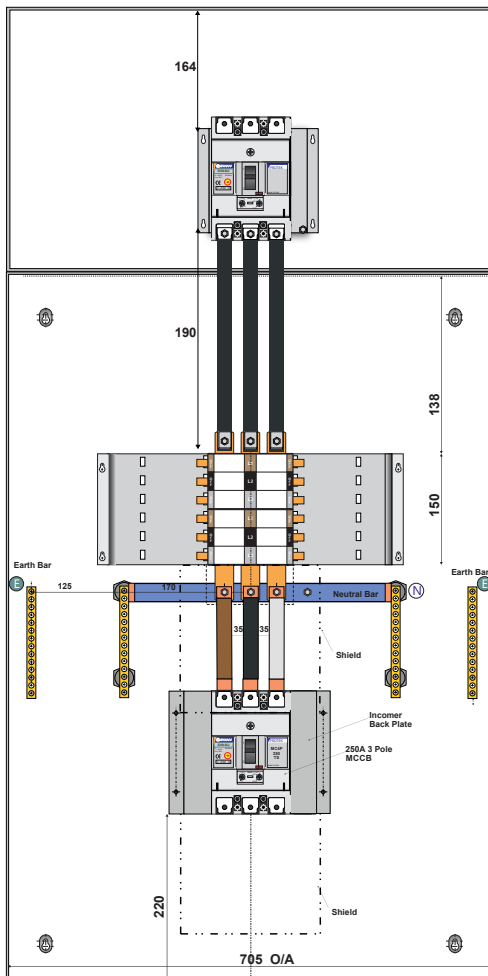
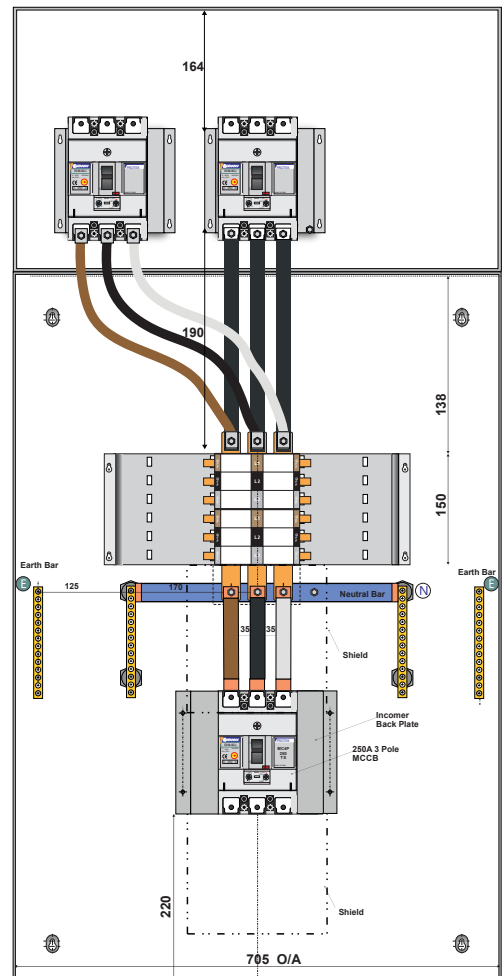

Introduction
160A - 250A 3 Pole MCCB Outgoing kits for use with ERIS 400A MCCB Panel Boards

- ▶ Designed and built in the UK.
- ▶ Fixed adjustable current setting of MCCBs
- ▶ Manufactured and tested to BSEN61439 parts 1 & 2.
- ▶ Offers the option to use MCCBs above 125A rating.
- ▶ Designed in the UK to BSEN61439.
- ▶ Fully tested prior to dispatch.
- ▶ Supplied with MCCBs, links and enclosure which bolts to the top of the panel board.

Specification

Product Code	Supplied MCCB	Current Range	Pole	kA Rating	Adj. Thermal	Adj. Magnetic	Palm Width	Frame Size	Bolt Size
ERSKM160LTS	1 x 160A	100A-160A	3 Pole	16kA	Yes	Yes	22mm	E250	M8
ERSKM160L2TS	2 x 160A	100A-160A	3 Pole	16kA	Yes	Yes	22mm	E250	M8
ERSKM160L3TS	3 x 160A	100A-160A	3 Pole	16kA	Yes	Yes	22mm	E250	M8
ERSKM200LTS	1 x 200A	125A-200A	3 Pole	16kA	Yes	Yes	22mm	E250	M8
ERSKM200L2TS	2 x 200A	125A-200A	3 Pole	16kA	Yes	Yes	22mm	E250	M8
ERSKM200L3TS	3 x 200A	125A-200A	3 Pole	16kA	Yes	Yes	22mm	E250	M8
ERSKM250LTS	1 x 250A	160A-250A	3 Pole	16kA	Yes	Yes	22mm	E250	M8
ERSKM250L2TS	2 x 250A	160A-250A	3 Pole	16kA	Yes	Yes	22mm	E250	M8
ERSKM250L3TS	3 x 250A	160A-250A	3 Pole	16kA	Yes	Yes	22mm	E250	M8

ERSKM160/200/250LTS

ERSKM160/200/250L2TS

4 Way panel board shown with incomer fitted. Panel boards purchased separately.

Technical Illustrations

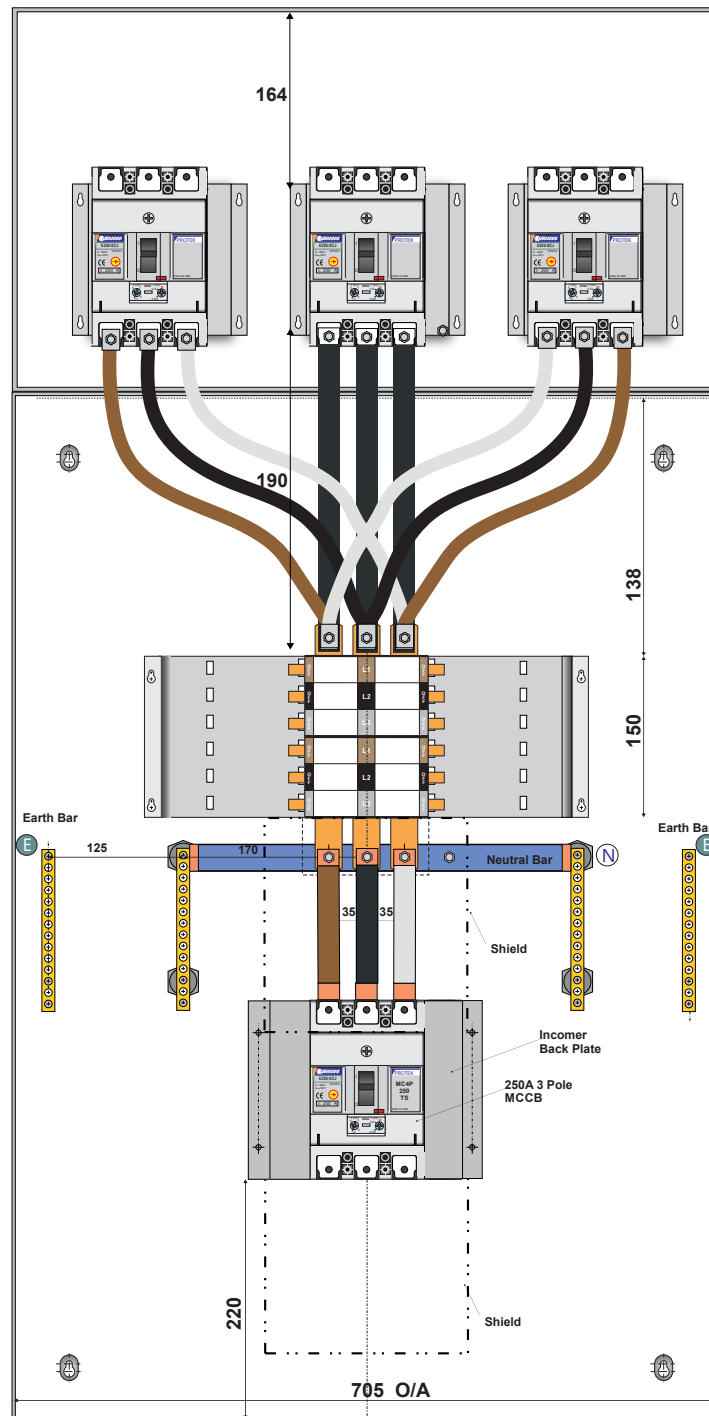
ERSKM160/200/250L3TS



4 Way panel board shown with incomer fitted. Panel boards purchased separately.