

5 Year
Warranty

LED

IP65

5000K

50.000h



LED NCF

CRI
Ra:80

PF
>0.90

-20°C
+45°C
*

220 -
240V

50/60
Hz



Installation Instructions



Please read these instructions carefully before installation

Leave a copy for the user/maintenance engineer for future reference

Important Safety Information

- Before commencing any installation or maintenance work, ensure that the electricity supply is disconnected / isolated.
- It is recommended that this fitting is installed, inspected and maintained by a qualified Electrician.
- Installation should be carried out in accordance with the latest edition of the IET Wiring Regulations (BS 7671) and the latest local Building Regulations. If in doubt, consult a qualified electrician.
- This product is designed for connection to a 220-240V ~ 50/60Hz mains supply.
- Ensure that all electrical connections are tight with no loose strands including factory made connections.
- Note the IP rating of this luminaire when deciding the location for installation.

Do not DRILL THROUGH THE BODY of this luminaire. Always use the mounting kit provided. Any drilled holes during installation will invalidate the product IP rating and warranty will be void.

- This luminaire is suitable for indoor and outdoor use.
- The LED Driver is non-dimmable.
- This is a class I construction luminaire which must be earthed.
- Suitable for use in ambient area temperatures of -20°C to +45°C. (Standard Luminaire) 0°C to +45°C (Emergency Luminaire).
- Do not carry out insulation resistance tests with the luminaire connected to the circuit.
- MCBs may require to be updated to allow for increased inrush current.
- This product contains a light source of energy efficiency class E
- The Light Source and Control Gear contained in this luminaire shall only be replaced by the manufacturer or his service agent or similar qualified professional person.

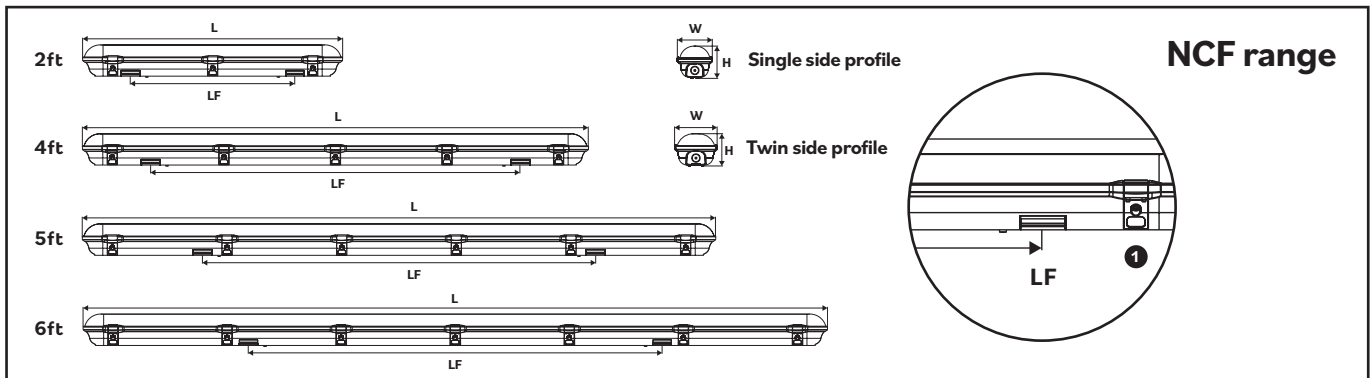

Technical Specifications

Part No.	Description	Wattage	Measurement L x W x H	Fixing LF	Lumen Output	IP Rating	Class Rating	Weight	*Operating Temperature	Power Factor	CRI Ra	Colour Temp.	No. of Clips
Standard													
LXNCF12LEDCW	2ft Single	12W	632 x 85 x 81mm	400mm	1440 Lm	IP65	Class I	0.8kg	-20°C ~ +45°C	>0.90	>80	5000K	6
LXNCF22LEDCW	2ft Twin	20W	632 x 103 x 81mm	400mm	2400 Lm	IP65	Class I	0.9kg	-20°C ~ +45°C	>0.90	>80	5000K	6
LXNCF14LEDCW	4ft Single	20W	1232 x 85 x 81mm	900mm	2400 Lm	IP65	Class I	1.3kg	-20°C ~ +45°C	>0.90	>80	5000K	10
LXNCF24LEDCW	4ft Twin	40W	1232 x 103 x 81mm	900mm	4800 Lm	IP65	Class I	1.5kg	-20°C ~ +45°C	>0.90	>80	5000K	10
LXNCF15LEDCW	5ft Single	30W	1532 x 85 x 81mm	950mm	3600 Lm	IP65	Class I	1.5kg	-20°C ~ +45°C	>0.90	>80	5000K	12
LXNCF25LEDCW	5ft Twin	60W	1532 x 103 x 81mm	950mm	7200 Lm	IP65	Class I	1.9kg	-20°C ~ +45°C	>0.90	>80	5000K	12
LXNCF16LEDCW	6ft Single	40W	1800 x 85 x 81mm	1000mm	4800 Lm	IP65	Class I	1.9kg	-20°C ~ +45°C	>0.90	>80	5000K	14
LXNCF26LEDCW	6ft Twin	80W	1800 x 103 x 81mm	1000mm	9600 Lm	IP65	Class I	2.2kg	-20°C ~ +45°C	>0.90	>80	5000K	14
Emergency													
LXNCF22LEDCW/EM3	2ft Twin EM3	20W	632 x 103 x 81mm	400mm	2400 Lm	IP65	Class I	1.2kg	0°C ~ +45°C	>0.90	>80	5000K	6
LXNCF14LEDCW/EM3	4ft Single EM3	20W	1232 x 85 x 81mm	900mm	2400 Lm	IP65	Class I	1.6kg	0°C ~ +45°C	>0.90	>80	5000K	10
LXNCF24LEDCW/EM3	4ft Twin EM3	40W	1232 x 103 x 81mm	900mm	4800 Lm	IP65	Class I	1.8kg	0°C ~ +45°C	>0.90	>80	5000K	10
LXNCF15LEDCW/EM3	5ft Single EM3	30W	1532 x 85 x 81mm	950mm	3600 Lm	IP65	Class I	1.8kg	0°C ~ +45°C	>0.90	>80	5000K	12
LXNCF25LEDCW/EM3	5ft Twin EM3	60W	1532 x 103 x 81mm	950mm	7200 Lm	IP65	Class I	2.2kg	0°C ~ +45°C	>0.90	>80	5000K	12
LXNCF16LEDCW/EM3	6ft Single EM3	40W	1800 x 85 x 81mm	1000mm	4800 Lm	IP65	Class I	2.2kg	0°C ~ +45°C	>0.90	>80	5000K	14
LXNCF26LEDCW/EM3	6ft Twin EM3	80W	1800 x 103 x 81mm	1000mm	9600 Lm	IP65	Class I	2.5kg	0°C ~ +45°C	>0.90	>80	5000K	14

Important Installation Information

Select a suitable mounting position and use the correct fixings for the type of surface. **DO NOT DRILL THROUGH THE BODY OF THE PRODUCT.** Ensure that the site of the installation can support the weight of the luminaire and that there is adequate free air ventilation around the luminaire at all times. The installation must not infringe on gas/water pipes or any other electrical cables or mechanical services which may be hidden behind the mounting surface. For surface mounting, follow the instructions below. For chain or wire suspension mounting, use the V shaped hook accessory provided in the pack. Attach the V hooks to the surface mount brackets **7** using the side holes. Ensure that the accessory pack is completely removed from the luminaire prior to operation.

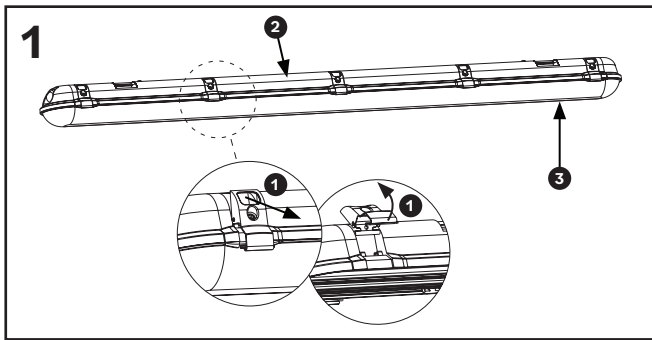

Isolate the mains power supply before commencing installation. To access the luminaire interior, lift and release the steel clips **1** on each side of the base **2** and remove the diffuser **3**.

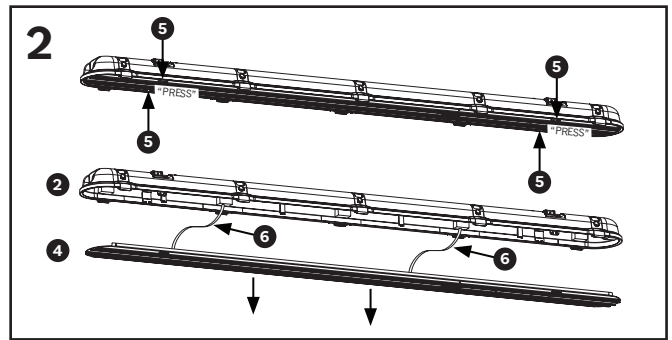

Remove the gear tray **4** from the base **2** by pressing the spring fixing clips **5** inwards. Retaining straps **6** prevent the gear tray from falling during installation and servicing.

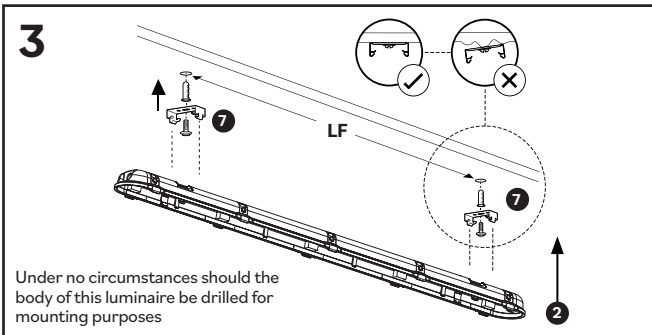

Under no circumstances should the body of this luminaire be drilled for mounting purposes

Mark and drill 2 fixing holes for the surface mount brackets provided **7**. Mount the brackets securely to the ceiling at the correct fixing centres (LF) for the version being installed (see table for LF). Offer the base **2** up to the brackets **7** and push to 'Snap fit'

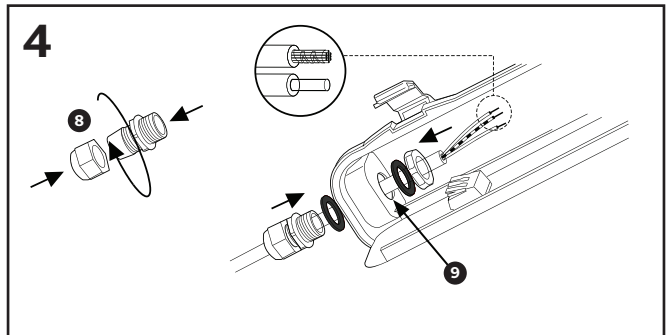

Fit the cable gland **8** and mains supply cable through the cable gland entry point at the end of the base **9**. It is the installer's responsibility to ensure that the gland is correctly fitted to maintain the IP65 rating

5 Standard version connection	Emergency version connection
Connect: N - Neutral ⊕ - Earth L - Live	Connect: N - Neutral ⊕ - Earth L1 - Switched Live L2 - Permanent Live
220-240V 50/60Hz Class I ⊕	220-240V 50/60Hz Class I ⊕

Wire the mains supply cable to the terminal block and terminate, ensure that the correct polarity is observed.

Warning - This luminaire **MUST** be earthed

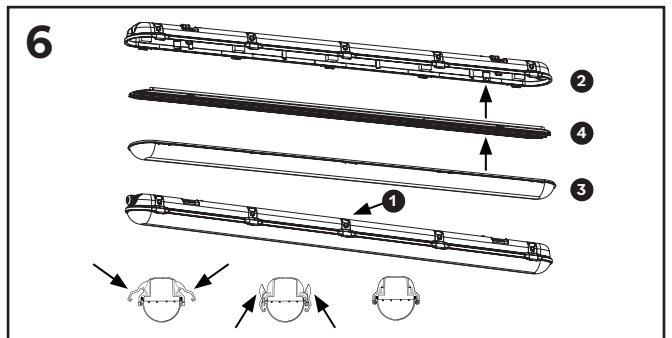

Refit the gear tray **4** onto the base **2** and ensure that it is securely fixed onto the spring fixing clips **5**. Replace the diffuser **3** and ensure that all the steel clips **1** are securely fastened to maintain the IP65 rating.

To lock the steel clips **1** for vandal resistance, use the small screws which are provided in the pack. Reconnect the power supply and test the installation for correct and satisfactory operation.

Emergency Luminaire Connection and Testing

- The Emergency luminaire requires an unswitched live supply L2 in addition to the switched live supply L1.
- Ensure that the battery cells supply cable is connected to the Emergency module before mains power is restored.
- Once installed, the batteries must be charged for a minimum of 24 hours before carrying out a full discharge and commissioning test to check that they are charging correctly and that the maintained 3-hour discharge duration is being achieved. The date should be noted on the battery.
- The Green LED Indicates that the batteries are charging.
- Emergency luminaires should be routinely inspected and tested in accordance with current **BS 5266** guidelines. Refer to **BS 5266 & BS EN 50172** for full Emergency Lighting requirements and testing procedures
- A log report must be completed and kept for the periodic test procedure. A copy of the Emergency test record sheet is included with this product. Further copies can be requested at sales@luxna.co.uk
- A completed copy of the Emergency test record sheet must accompany any product returned to the manufacturer.

Batteries: The battery cells inside an emergency product are a consumable replaceable item. The batteries have a normal operating designed service life of 4 years and must be replaced in a timely manner to ensure that the integrity of the emergency lighting system is maintained. The battery cells actual service life can be shortened by several variable factors including (but not limited to): Type of installation environment, Room temperature, Number of charge/discharge cycles, power supply interruptions etc. The product should be tested and maintained regularly according to the details within the instruction manual. Should the battery cells fail to provide the minimum rated discharge duration of 3 hours at any time during the products service life, they must be replaced. **Emergency luminaires must not be installed in areas where the ambient area temperature is above or below the recommended operating temperature range 0°C to +45°C**

Warranty: This product is protected by guarantee in the UK and EU for a period of 5 years warranty from the date of purchase against any defects in materials or workmanship. Should this product fail during the warranty period it will be repaired or replaced with the same or equivalent product free of charge, subject to providing the original receipt/invoice or proof of the original date of purchase and return of the faulty unit. If in our sole discretion, we are unable to repair or replace a defective product, we will refund the purchase price of the product. The warranty is invalid if in our judgment the product fails due to incorrect installation not conforming to our product instructions or installation within an improper working environment. The warranty will not apply if the product fails due to damage in storage, shipment, accident or misuse. Modification to the product in any way or removal of the batch number will void the warranty. Luxna Lighting does not accept responsibility for any installation, labour or travel costs which may be associated with the replacement or return of any faulty products. Our maximum liability under the terms of this warranty is limited to the purchase price of the product. Your statutory rights are not affected. Luxna Lighting reserves the right to alter product specifications without prior notification. Terms and conditions are also subject to change without prior notice.