

Orda II High-Efficient Twin spot LED emergency light

Please read these instructions thoroughly before use and retain for future reference.

The Emergency Twin Spot is a non-maintained luminaire only designed to work when the power is cut and must be connected to the un-switched permanent supply. The supply connection for the luminaire is the same for standard or self-test versions. Additional instructions are supplied for the function of the self-test version.

Safety Information

- The emergency fitting provides power in the event of a cut in the supply and must be wired to the un-switched supply.
- Before commencing installation, turn off and isolate the circuit to be worked on by removing the fuse or switching the circuit breaker off at the distribution board.
- Installation must be carried out in accordance with national building and wiring regulations.
- If you are in any doubt about installing this product, please consult a qualified electrician.
- This product is suitable for connection to a 220-240Vac 50/60Hz supply.
- This is a **Class II, IP65** rated product not requiring an earth though a terminal is provided for continuity.
- The emergency fitting is not suitable for use on a battery supply, trickle or intermittent re-charging circuit.
- The emergency fitting is not protected against supply voltage polarity reversal.
- The recharging device will recharge the battery normally after removal of a battery short-circuit
- When cutting holes, drilling or screwing take care not to damage existing wiring or pipework.

Products Covered:

ORD03-WHT

ORD03-BLK

ORD03-WHT/ST

ORD03-BLK/ST

Installation Information

- Referring to the diagram supplied as below for wall installation and ceiling installation.
- Ensure that all electrical connections are tighten with no loose strands and secure any glands as necessary.
- **Ensure battery is connected.**
- Write the commissioning date on the battery label.

Adjusting the Heads

- The twin spotlight heads can be adjusted by loosening the screws towards the base of each head then securing in position.

Standard Version Manual Testing

(See later section for self-test details)

- The battery leaves the factory in a semi-charged state but may take up to 24 hours to fully charge for a 3-hour test. Charge for 5 minutes before performing a functional test to ensure there is some charge in the battery.
- A quick functional test can be performed by pressing the test button on the side of the unit.
- To fully test the emergency function, the un-switched supply will need to be turned off.
- Replace the battery when the luminaire fails to meet the 3-hour duration requirement in testing.

Indicator LED

- For the manual test version, during charging the LED indicator on the side of the fitting should illuminate green.
- For the self-test version, please see later section for details of the LED indicator.

Battery Replacement

- Turn off and isolate the circuit to be worked on by removing the fuse or switching the circuit breaker off at the distribution board.
- Remove the front cover by unscrewing the four recessed screws.
- Disconnect the battery cable from the battery socket on the emergency module.
- Remove the two battery retaining screws.
- Install and reconnect the new battery.
- Write the commissioning date on the battery label.
- Replace the cover and reconnect the supply.

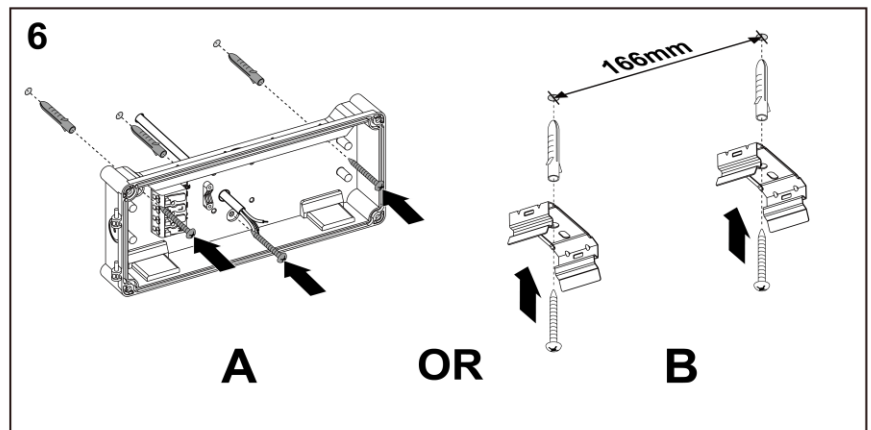
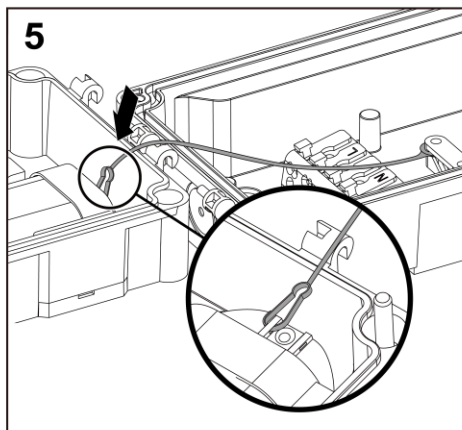
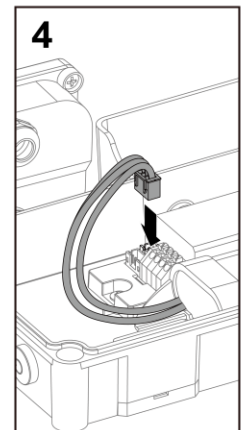
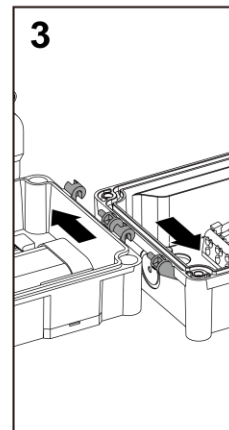
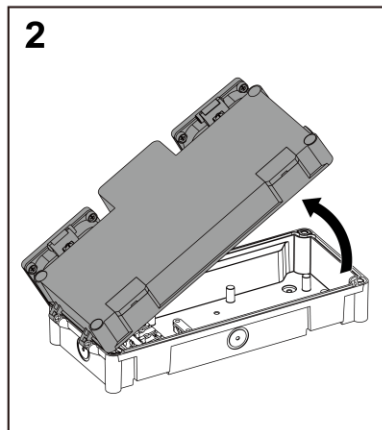
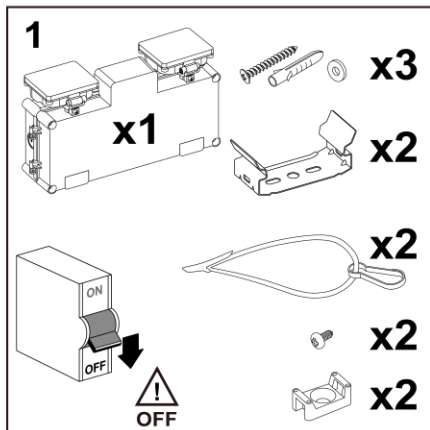

A. Wall Mounting

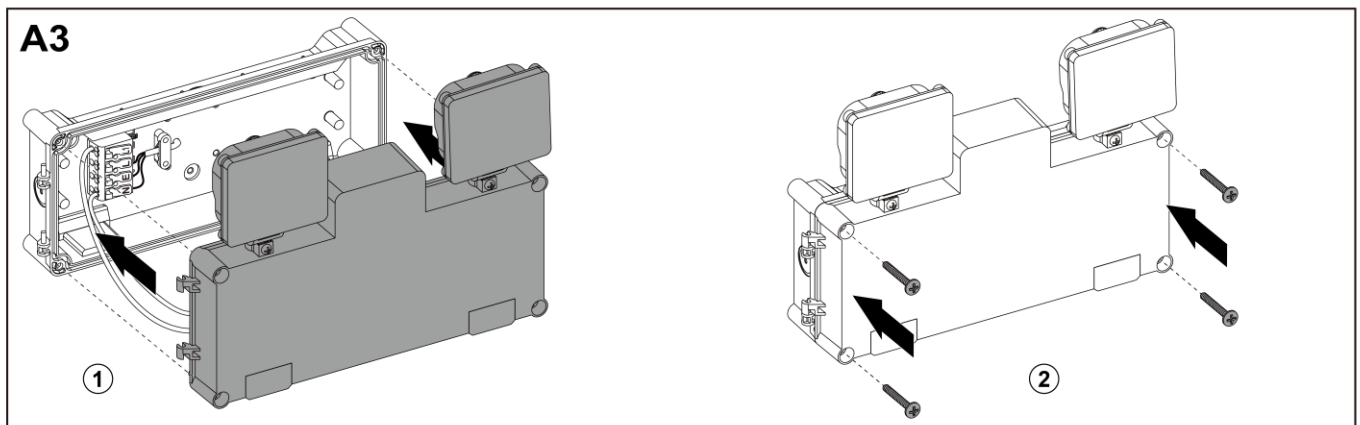
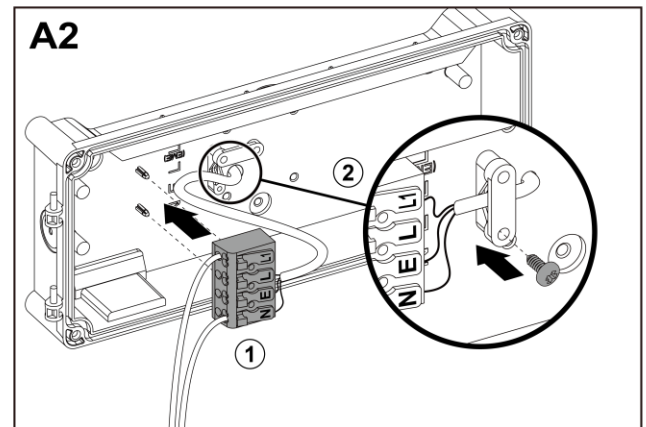
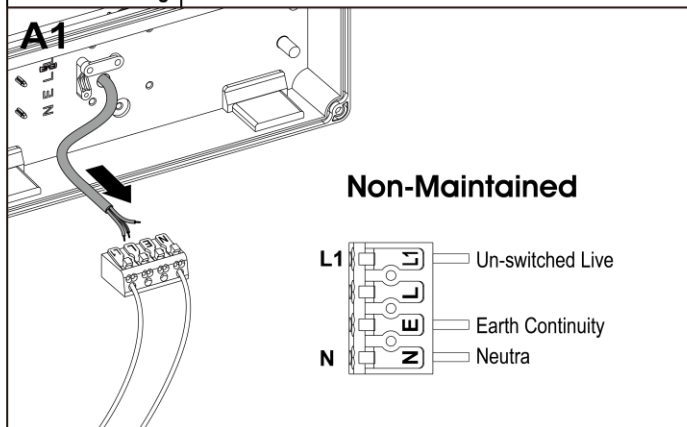

B. Ceiling Mounting

B1

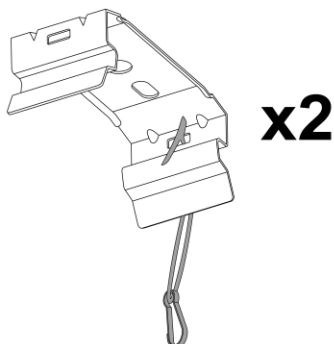

B2

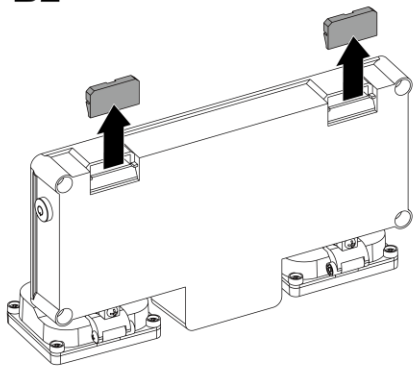

B3

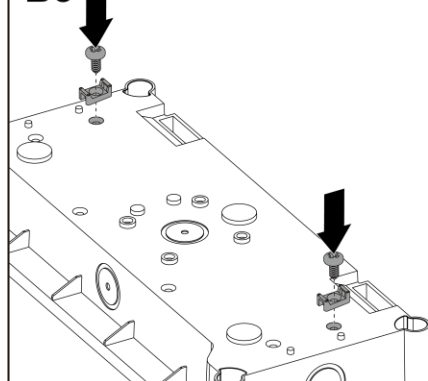

B4

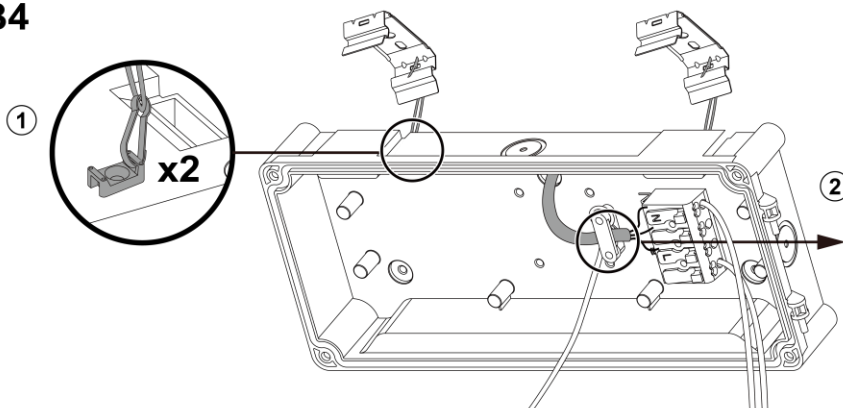

Non-Maintained

| | | |
|-----------|--|------------------|
| L1 | | Un-switched Live |
| N | | Earth Continuity |
| | | Neutra |

B5

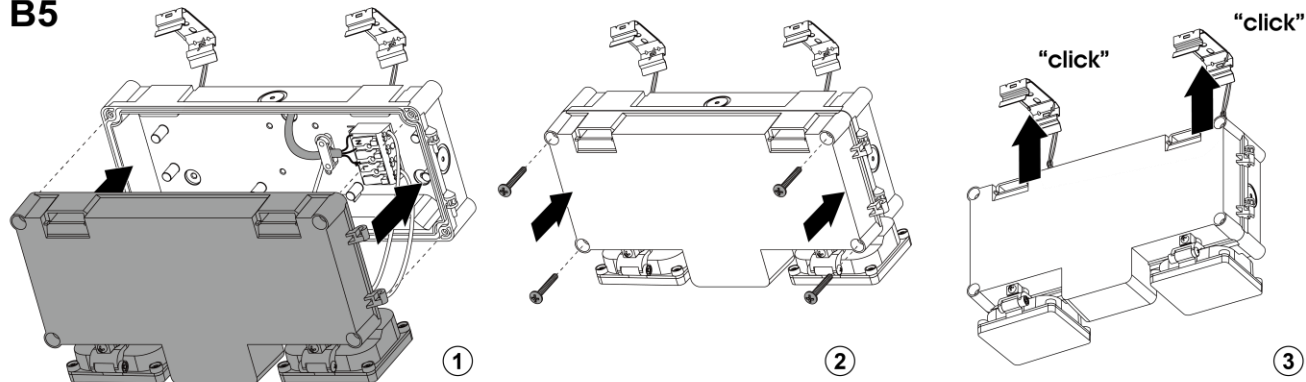

7

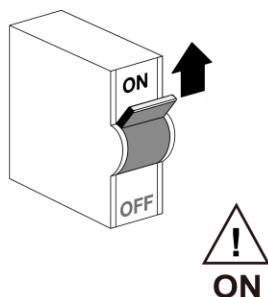

8

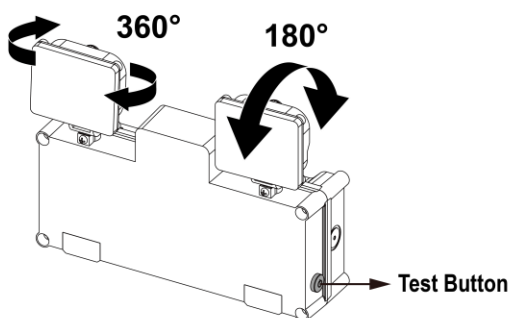

A. Wall Mounting

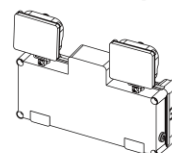

B. Ceiling Mounting

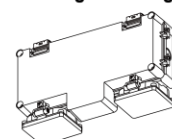

The Waste Electrical & Electronic Equipment Regulations (WEEE) requires that products bearing this symbol must not be disposed of with household waste as they may contain substances harmful to the environment. The Local Authority can provide advice on recycling.

Automatic Self-Test Emergency User Guide







Please read these instructions thoroughly before use and retain for future reference.

If you are in any doubt about using this product, please consult a qualified electrician.

Commissioning

- Commissioning takes place by connecting the battery and then the un-switched supply. The battery must be connected first.
- The green LED will immediately flash 1 x second to indicate that there is a pending duration test.
- A duration test will occur at a random point between 24 hours and 48 hours after commissioning to allow 24 hours for battery charging.
- Any faults found in the duration testing will be reported via the LED indicator, as detailed below.
- Disconnecting the un-switched supply and then the battery resets the emergency module, clears all fault reports and forces a re-commission when the battery and then power supply are reconnected. Press the manual test button for 5-10 seconds to re-commission the emergency module.

LED Indicator

| | | | | | |
|---|-------------------------------|----------------------------------|---|-----------------------------|----------------------------------|
|  | Green | = System Healthy |  | Red | = Battery Charging Fault |
|  | Green Flash 1 x Second | = Duration Test Pending |  | Red Flash 2 x Second | = Battery Duration Fault |
|  | Green Flash 2 x Second | = Duration Test Running |  | Red Flash 4 x Second | = Lamp or Luminaire Fault |
|  | Green Flash 4 x Second | = Functional Test Running | | | |

Duration Testing (3 hours)

- An automatic duration test will occur at a random point between 24 hours and 48 hours after commissioning to allow for battery charging.
- An automatic duration test will occur annually at a random point in the 52nd week of each year.
- A duration test will occur at a random point between 0 and 24 hours after pressing the manual test button for 5-10 seconds. Time will be added to allow the battery to charge if the battery has been charging less than 24 hours.
- A duration test may be delayed by other events, such as a power cut that interrupts the test or a lack of charging time, in which case the green LED will flash 1 x second to indicate there is a pending duration test that the emergency module has rescheduled.
- Any faults found in the duration testing will be reported via the LED indicator, as detailed above.
- A functional test will not override any faults reported by a duration test. A full duration test or re-commissioning is required to clear any faults.

Functional Testing (<2 minutes)

- A short automatic functional test will occur every 7 days.
- A manual functional test will start immediately after pressing the manual test button for 1-2 seconds.
- Any faults found in the functional testing will be reported via the LED indicator, as detailed above.
- A functional test will not override any faults reported by a duration test. A full duration test or re-commissioning is required to clear any faults.

Manual Testing

- Manual functional test: Press the manual test button for 1-2 seconds. A manual functional test lasting <2 minutes will start immediately.
- Manual duration test: Press the manual test button for 5-10 seconds. A manual duration test will occur at a random point between 0 and 24 hours after pressing the manual test button for 5-10 seconds. Time will be added to allow the battery to charge if the battery has been charging less than 24 hours.

Pending Duration Tests

- A duration test may be delayed by other events, such as a power cut that interrupts the test or charging period, in which case the green LED will flash to indicate there is a pending duration test that the emergency module has rescheduled until charging is complete.

Lamp or Luminaire Fault

- Turn off the supply and replace or correct the fault with the lamp or luminaire, and then reconnect the supply.
- Press the manual test button for 5-10 seconds. A manual duration test will occur at a random point between 24 and 48 hours later to allow the battery to charge fully.
- If the battery and power have been disconnected the module will re-commission and automatically test the replacement.
- A successful functional test will not override any faults reported by a duration test. A full duration test or re-commissioning is required to clear fault reports.

Battery Fault

- Turn off the un-switched supply to the emergency module and replace the battery, and then reconnect the supply.
- If the fault was because the battery was not connected, the un-switched supply must still be turned off when connecting the battery to clear the battery fault.
- The emergency module will re-commission and so automatically test the replacement at a random point between 24 and 48 hours after commissioning to allow for battery charging.