

# Installation Instructions

## Tamar Anti-Corrosive

Input	220-240V AC 50/60Hz
Power	10/20   20/40   25/50   30/60
Operating Temp	0–40°C
Connection Type	Push-Fit Terminal
Emergency Option	430962 (Sold separately)
Control Connection	430916 (Sold separately)
Light Source Energy Rating	B



### Box Contents:

- Tamar Anti-Corrosive
- Fixing Kit



Selectable  
Emergency



Professionally  
Replaceable



Professionally  
Replaceable



Class  
I



Ingress  
Protection



Scan for more  
Information.

### Tools Required For Installation:

- Wire Strippers / Cutter

\* Please note P&P Emergency not available in 2ft Tamar

### Dimensions:

Part No.	Description	L (mm)	W (mm)	H (mm)	LF (mm)	Weight
431350	Tamar 10W/20W 2ft Twin*	610	75	81	285	0.75Kg
431351	Tamar 20W/40W 4ft Twin	1165	75	81	810	1.5Kg
431352	Tamar 25W/50W 5ft Twin	1465	75	81	950	2.0Kg
431353	Tamar 30W/60W 6ft Twin	1795	75	81	1200	2.0Kg

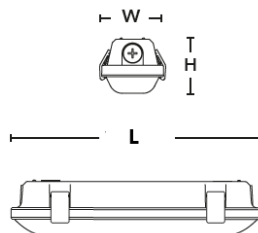

### End Of Life Disposal:

Disassembly instructions for end of life disposal available on website.  
Disposal of Electronic Equipment WEEE Directive 2002/96/EC This product falls within the scope of the Waste Electrical & Electronic Equipment Directive (WEEE), which means the product should not be disposed of as normal household waste. Please recycle where facilities exist or check with your Local Authority. RoHS – All components and materials used in this product are RoHS 2002/95/EC compliant. Specifications may change from time to time. The information contained in this leaflet is for guidance only and should not be considered as always accurate and should be treated as not representative.



**READ THESE INSTRUCTIONS THOROUGHLY BEFORE INSTALLATION  
KEEP THESE INSTRUCTIONS FOR FUTURE REFERENCE.**

### IMPORTANT:

This product must be installed by a qualified electrician or competent person, and in accordance with current building and IET wiring regulations.

### Warranty:

This luminaire is warranted for a period of 5 Years from the date of purchase\*\*. The warranty could be invalidated should the light fitting not be installed according to these instructions, outside the scope of the specification or the product has been altered or tampered with in any way. Please see website for terms and conditions.



**WARNING: Risk of electric shock!**  
**Isolate the mains power before proceeding.**

- Turn off the mains power before performing inspections, installation, or removal
- Verify that the supply voltage is correct by comparing it with the luminaire label information
- It is the installers responsibility to ensure installation is suitable for the total load of the luminaire(s). The supply cable, fuses/circuit breakers must be correctly rated for the electrical load and considering for any transient inrush currents that may occur.
- Do not perform insulation strength or resistance tests on installed luminaire(s) connected

**Installation Procedure:**

1. Disconnect the mains supply
2. Install the fitting in desired location.
3. Open the fitting by undoing the fastening clips.
4. Thread the incoming power cable through the cable gland
5. Connect mains to terminal block as indicated–Standard version.
6. Connect mains to terminal block as indicated–Emergency version
7. Re-fit the diffuser & secure with the fastening clips.
8. Reconnect the mains supply.

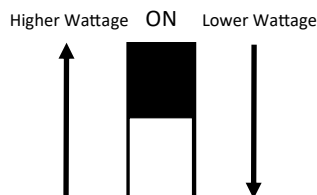

4ft		5ft		6ft	
Watts	Wattage Select	Watts	Wattage Select	Watts	Wattage Select
20W	ON 	25W	ON 	30W	ON 
40W	ON 	50W	ON 	60W	ON 

Wattage selection dip switch, located on LED driver, choose colour temperature before re-fitting the diffuser.

1.

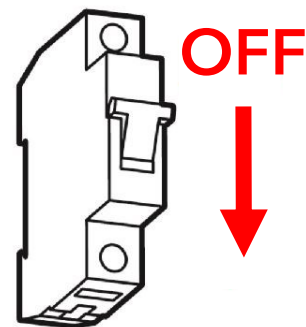

2.

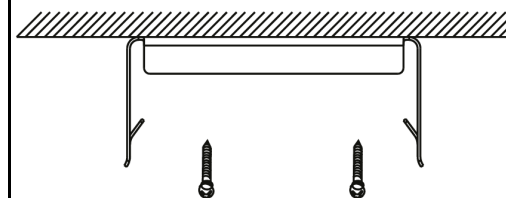

3.

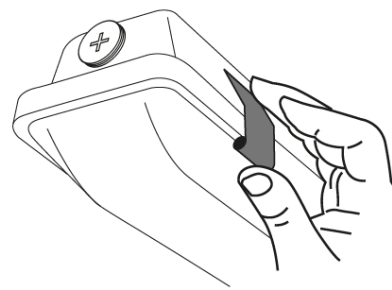

4.

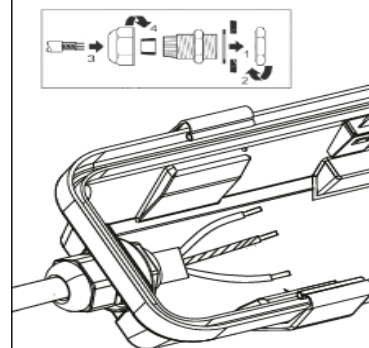

5.

**Electrical connection wiring**

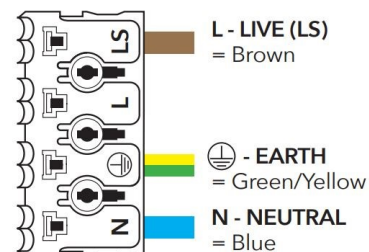

6.

**EMERGENCY FITTINGS ONLY.  
EARTH CONNECTION REQUIRED.**

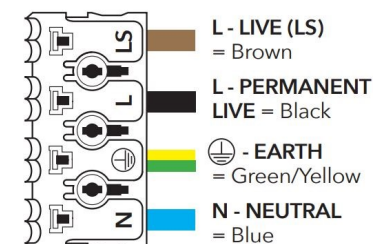

7.

