

Emergency Modules

For use with LXBAT/LXNCF/LXSL PRO



LXLN/EMM



LXLN/EMM/ST



Emergency Luminaire Connection and Testing

1. The Emergency luminaire requires an unswitched live supply LP in addition to the switched live supply LS.
2. Ensure that the battery cells supply cable is connected to the Emergency module before mains power is restored.
3. Once installed, the batteries must be charged for a minimum of 24 hours before carrying out a full discharge and commissioning test to check that they are charging correctly and that the maintained 3-hour discharge duration is being achieved. The date should be noted on the battery.
4. The Green LED Indicates that the batteries are charging.
5. Emergency luminaires should be routinely inspected and tested in accordance with current **BS 5266** guidelines. Refer to **BS 5266 & BS EN 50172** for full Emergency Lighting requirements and testing procedures.
6. A log report must be completed and kept for the initial commissioning and periodic test procedure. A copy of the Emergency test record sheet can be downloaded by scanning the product QR Code above. Further copies can be requested at sales@luxna.co.uk.
7. A completed copy of the Emergency test record sheet must accompany any product returned to the manufacturer.

Emergency luminaires must not be installed in areas where the ambient area temperature is above or below the recommended operating temperature range 0°C to +40°C

Installation Instructions

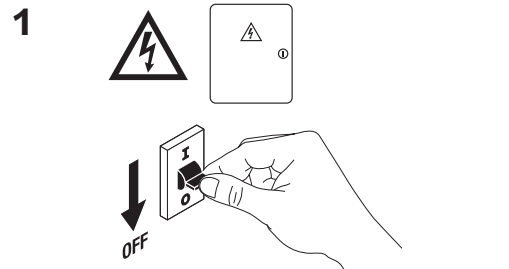

Before commencing any installation or maintenance work, ensure that the electrical mains supply is isolated and circuit fuses are switched off.

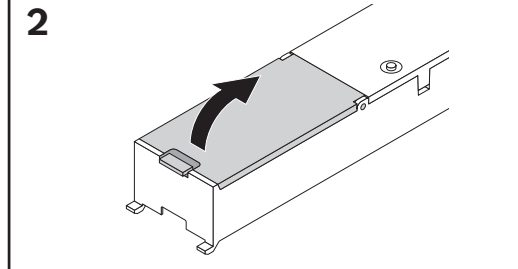

Open the lid marked **Press to open** on the emergency module to access the battery compartment. Remove the battery.

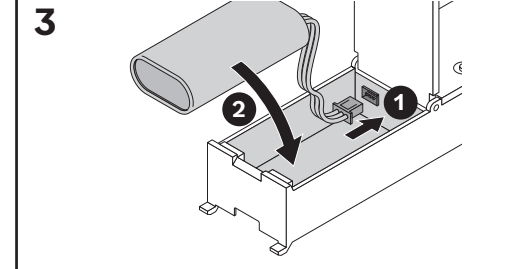

Connect the battery cable plug to the terminal **1** inside the battery compartment as shown. Replace the battery **2** into the compartment.

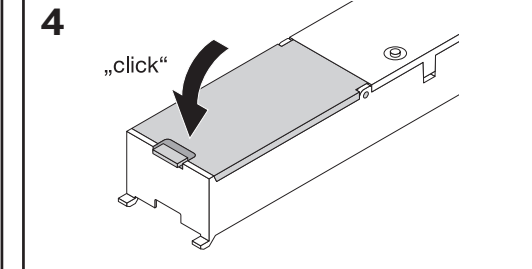

Close the emergency module battery compartment lid.

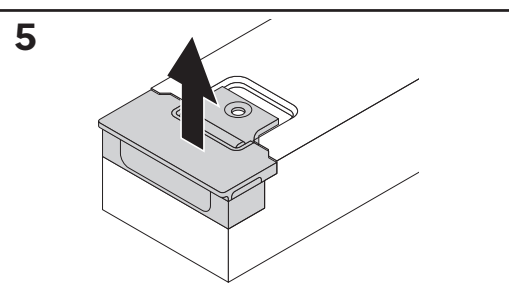

Remove the LED Driver module cover cap marked **Press to open** to access the connection socket block.

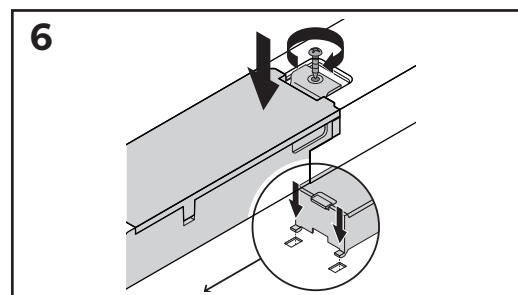

Remove the cover cap on the emergency module and locate the position marked **Emergency EM** on the housing. Insert the module housing tabs into the fixing plate then press-fit the module into the driver connection socket. Use the screw provided to securely fix the two modules.

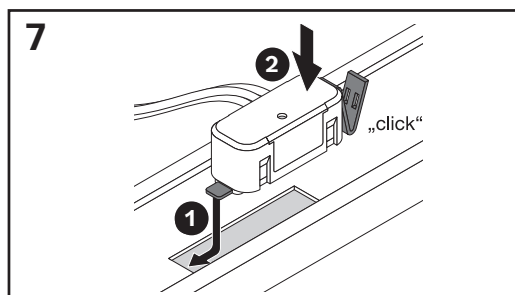

Locate the position marked Test Indicator on the housing adjacent to the module and insert the emergency LED indicator as shown above. Insert tab **1** first at a slight angle then press-fit bracket **2**.

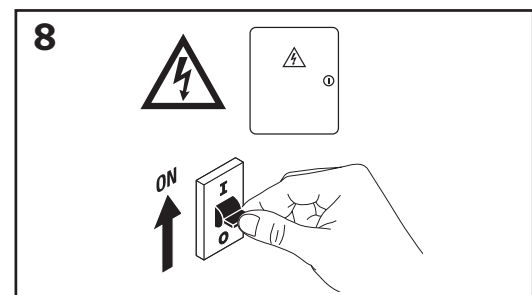

When the installation or maintenance work is complete. Restore the mains power supply, switch on and test for satisfactory operation.

See website for further details including warranty terms and conditions