

Installation Instructions

Instrucciones de instalación, Instructions d'installation, Installationsanleitung, إرشادات التركيب,
 Installatie-instructies, Instruções de instalação, Installatie-instructies,
 設置手順説明, Οδηγίες εγκατάστασης



Product Code: [ATORE /2/ Range]



Master Translations QR Link

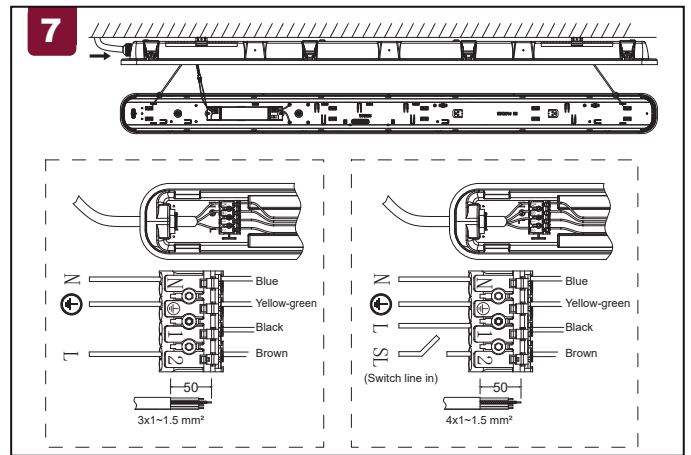
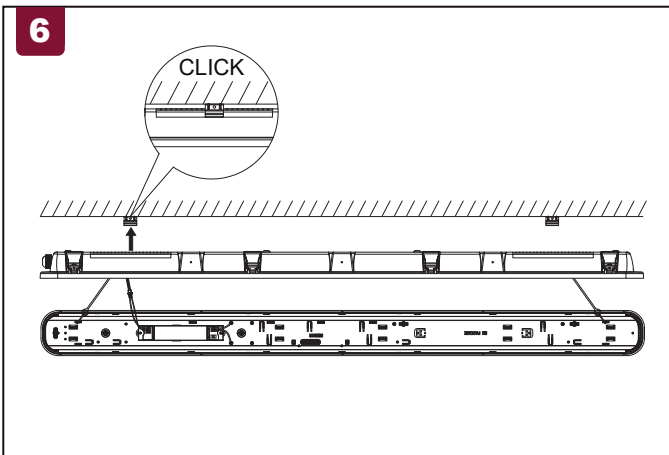
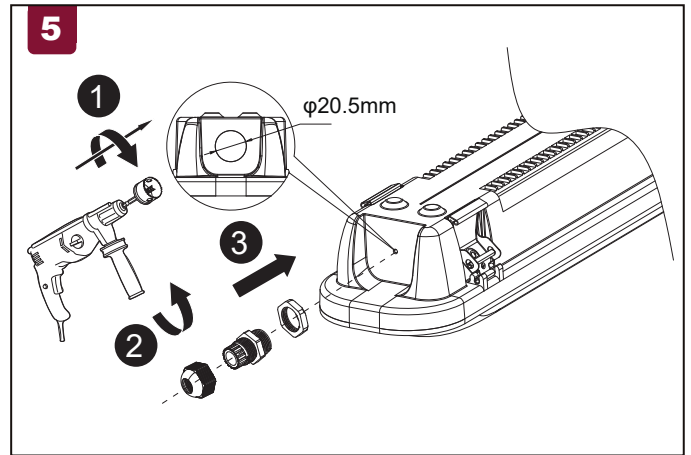
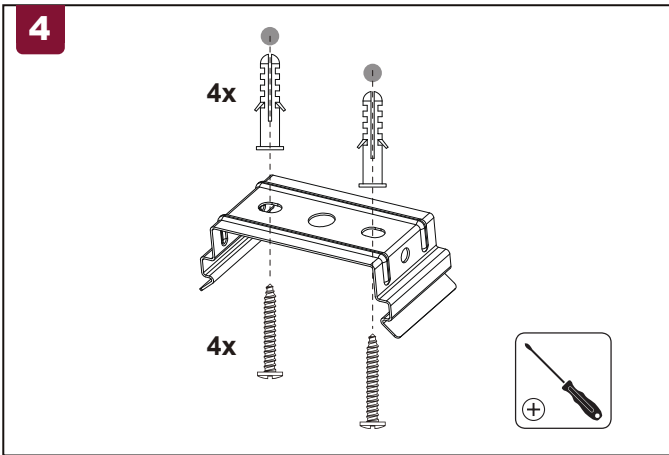
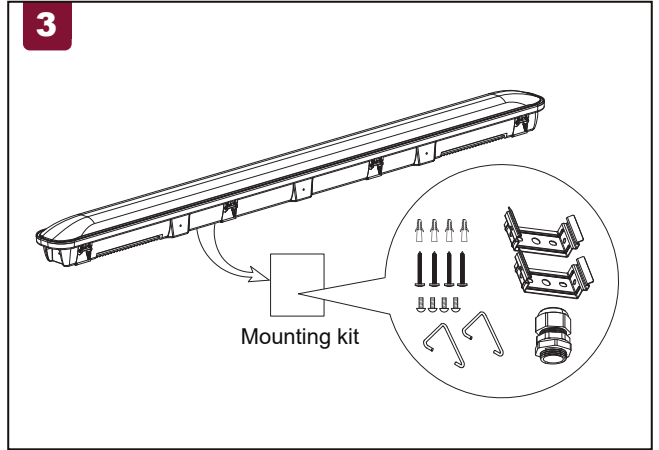
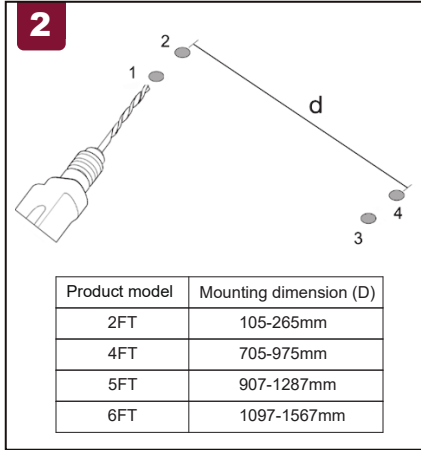
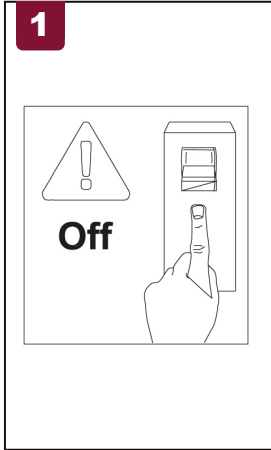
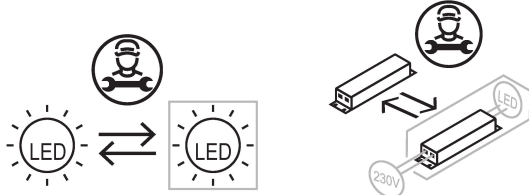
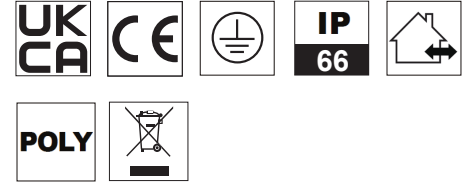

Ansell Electrical Products
 Unit 6B, Stonecross Industrial
 Park,
 Yew Tree Way,
 Warrington,
 WA3 3JD

Ansell (Sales & Distribution)
 Unit 2, M2 Business Park,
 Duncrue Street,
 Belfast,
 BT3 9AQ

Ansell (Sales & Distribution) Republic of Ireland Limited
 Unit G1, Block G,
 Calmount Park, Ballymount
 Dublin 12,
 D12 TH56

www.ansell-lighting.com

Warrington Tel: +44 (0)1942 433333

Belfast Tel: +44 (0)2890 773750

International Tel: +44 (0)1942 433343

Spain Tel: 00 34 938 005642

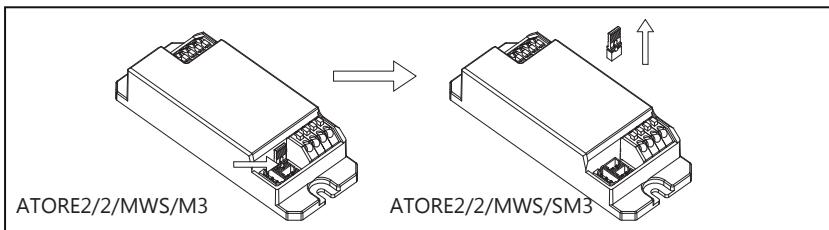
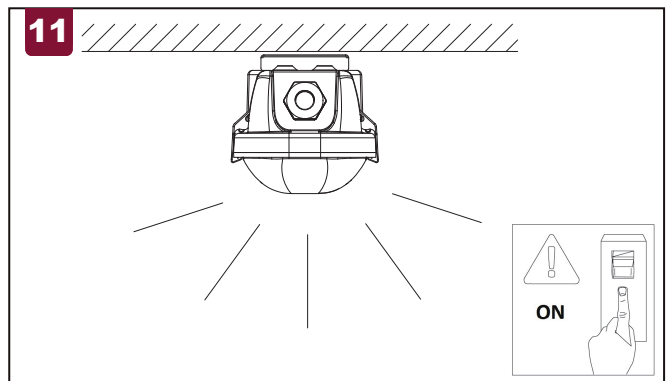
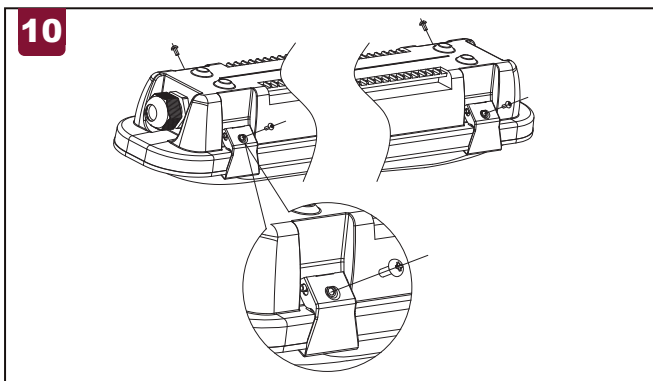
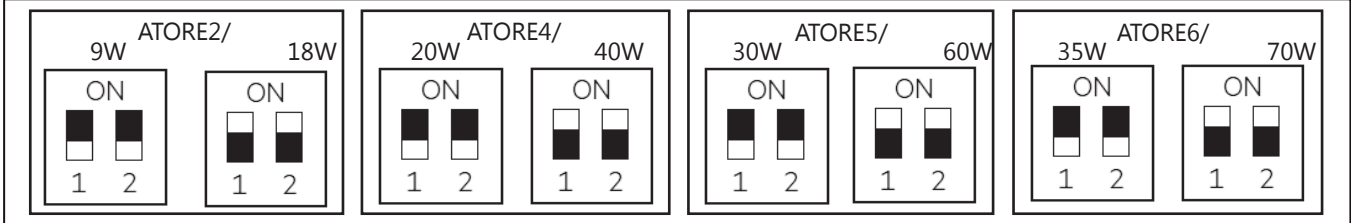
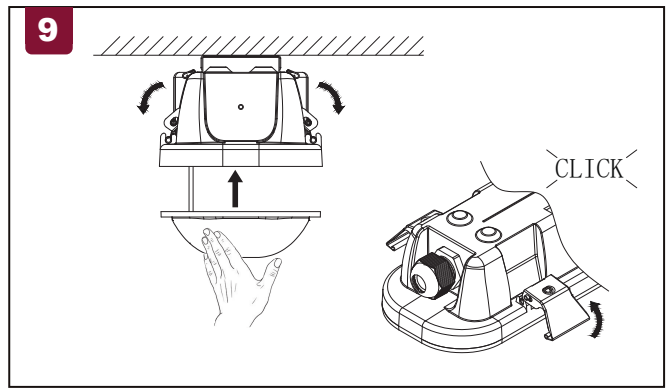
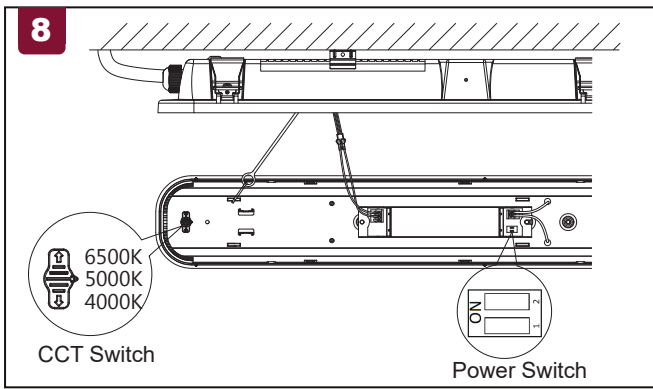

Emergency LED System Status

LED Indication	Status	Commentary
Permanent green	Standby, System OK	Mains Operation, battery is charged
Fast flashing green (0.25s on – 0.25s off)	Function test underway	Function test underway
Slow flashing green (1 s on – 1 s off)	Duration test underway	Duration test underway
Permanent Red	Lamp failure	Open Circuit or Short Circuit or LED failure
Fast flashing red (0.25 s on – 0.25 s off)	Battery capacity failure	Battery failed duration test
Slow flashing red (1 s on – 1 s off)	Battery fault	Incorrect battery voltage or Short Circuit or Open Circuit
Green and red off	Battery Operation	Emergency mode: Mains disconnected or Mains failure

NOTICE
Fault status:
If an error is detected, the indicator LED switches to RED. If the error has been corrected please re-connecting the battery after the mains power off, the indicator LED immediately switches back to GREEN when mains power on.

NOTICE
Battery failed duration test:
After an exchange of the battery and holding down the button (>10S) reset the timer, the indicator LED switches to GREEN.

Ansell Electrical Products
Unit 6B, Stonecross Industrial Park,
Yew Tree Way,
Warrington,
WA3 3JD

Ansell (Sales & Distribution)
Unit 2, M2 Business Park,
Duncrue Street,
Belfast,
BT3 9AQ

Ansell (Sales & Distribution) Republic of Ireland Limited
Unit G1, Block G,
Calmount Park, Ballymount
Dublin 12,
D12 TH56

www.ansell-lighting.com

Warrington Tel: +44 (0)1942 433333 Belfast Tel: +44 (0)2890 773750 International Tel: +44 (0)1942 433343 Spain Tel: 00 34 938 005642

Installation Instructions

Instrucciones de instalación, Instructions d'installation, Installationsanleitung, إرشادات التركيب, Installatie-instructies, Instruções de instalação, Installatie-instructies, 設置手順説明, Οδηγίες εγκατάστασης



Product Code:[ATORE /2 MWS]



Function

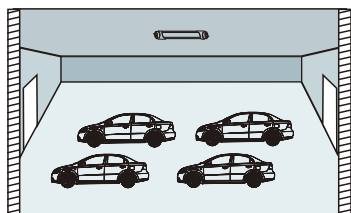

❶ With sufficient ambient light, the light will not be switched on even if with motion signal.

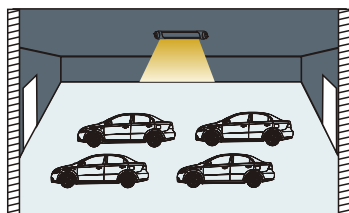

❷ With insufficient ambient light, the light switches on when motion is detected.

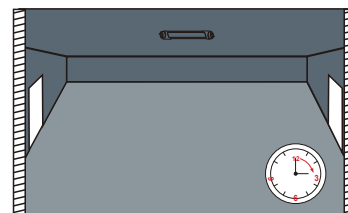

❸ After elapse of hold time, the light switches off when no motion is detected.

DIP Switch Setting

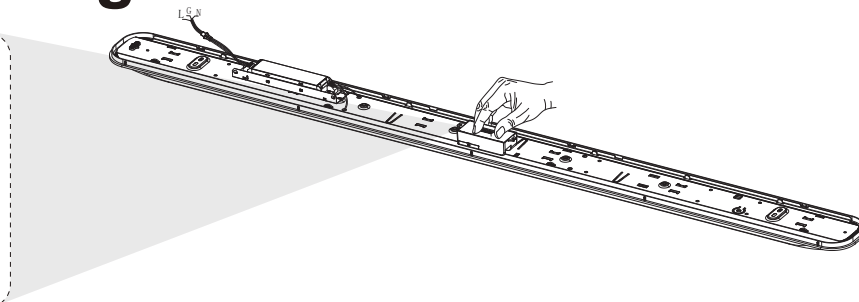
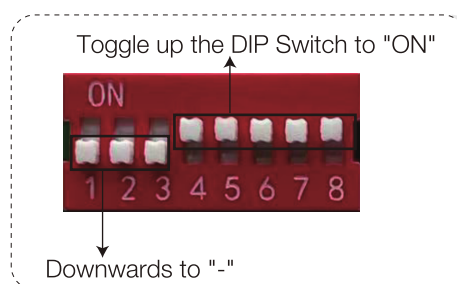

Daylight Sensor

	1	2	3	Daylight Sensor	Illuminance
I	ON	ON	ON	2Lux	Dark
II	-	ON	ON	10Lux	Twilight
III	-	ON	-	30Lux	Slightly bright
IV	-	-	ON	50Lux	Bright
V	-	-	-	Disable	No "daylight sensor" function

Hold Time

	4	5	6	Hold Time
I	ON	ON	ON	5s
II	ON	ON	-	30s
III	ON	-	ON	90s
IV	ON	-	-	5min
V	-	ON	ON	20min
VI	-	-	-	30min

When no one is detected, the light will be switched off after the "Hold time" elapses.

Detection Area

	7	8	Detection Area	Detection Radius
I	ON	ON	100%	Around 3 meters
II	ON	-	75%	Around 2.5 meters
III	-	ON	50%	Around 2 meters
IV	-	-	25%	Around 1 meters

The detection radius is closely related to the height and moving speed of the person/car, the installation location of the sensor, whether there are obstructions, and the reflection of metal or glass. The data in the table is for reference only and was tested by a 165cm person, facing the sensor with no obstructions, walking slowly at 0.3m/s in an open area with the sensor mounted of 3 meters. The detection area selection is subject to on-site installation environment adaptation.

Ansell Electrical Products
Unit 6B, Stonecross Industrial Park,
Yew Tree Way,
Warrington,
WA3 3JD

Ansell (Sales & Distribution)
Unit 2, M2 Business Park,
Duncrue Street,
Belfast,
BT3 9AQ

Ansell (Sales & Distribution) Republic of Ireland Limited
Unit G1, Block G,
Calmount Park, Ballymount
Dublin 12,
D12 TH56

www.ansell-lighting.com

Warrington Tel: +44 (0)1942 433333

Belfast Tel: +44 (0)2890 773750

International Tel: +44 (0)1942 433343

Spain Tel: 00 34 938 005642

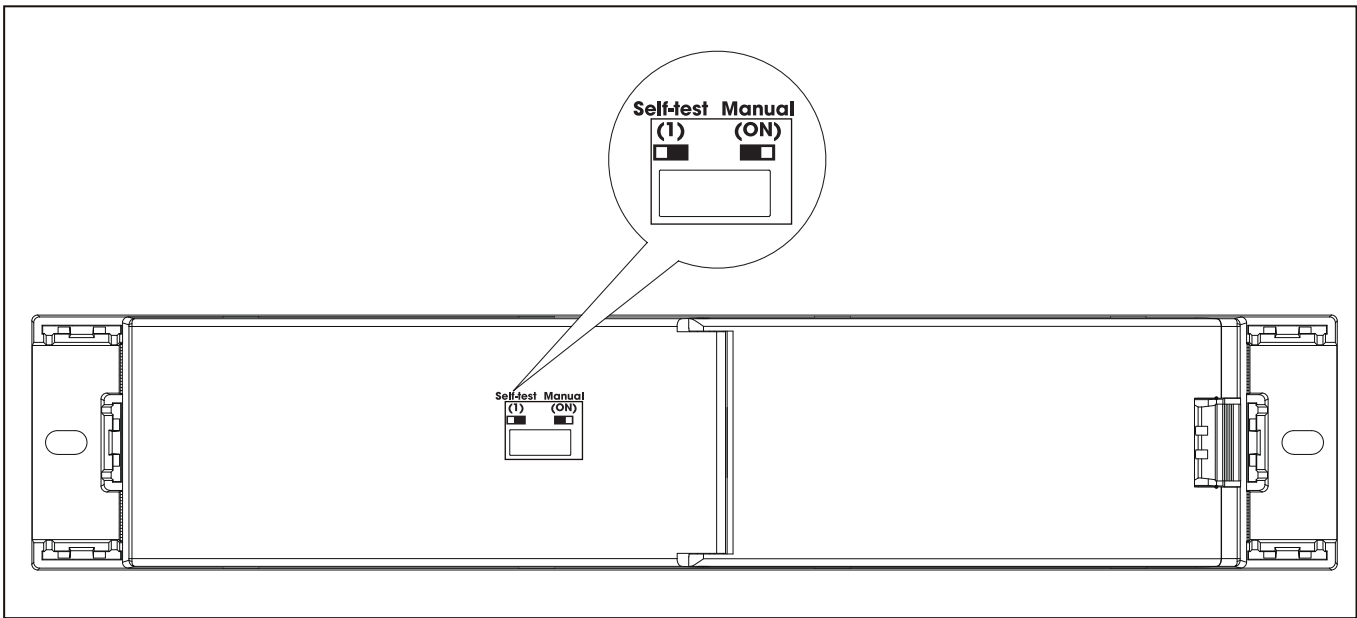

Emergency LED System Status						
LED indication	Description	Status	Manual Mode	Self-test Mode	Comment	
	Green Permanently On	System Healthy	✓	✓	AC Mode	
	Permanently OFF	Emergency Mode: Mains failure or mains disconnected	✓	✓		
		Battery Disconnected	✓	N/A		
		Battery Charge Inhibited	✓	✓	Battery outside operating temp	
	Green Slow Flash (1s on-1s off)	Duration Test Running	N/A	✓		
	Green Fast Flash (0.1s on-0.s off)	Functional Test Running	N/A	✓		
	Red Permanently On	Load Fault	N/A	✓	Open circuit/ LED failure	
	Red Slow Flash (1s on-1s off)	Battery Fault	N/A	✓	Battery failed the duration test or function test / Battery is defect or deep discharged/ Incorrect battery voltage	
	Red Fast Flash (0.1s on-0.s off)	Battery Charging Fault	N/A	✓	Incorrect charging current	

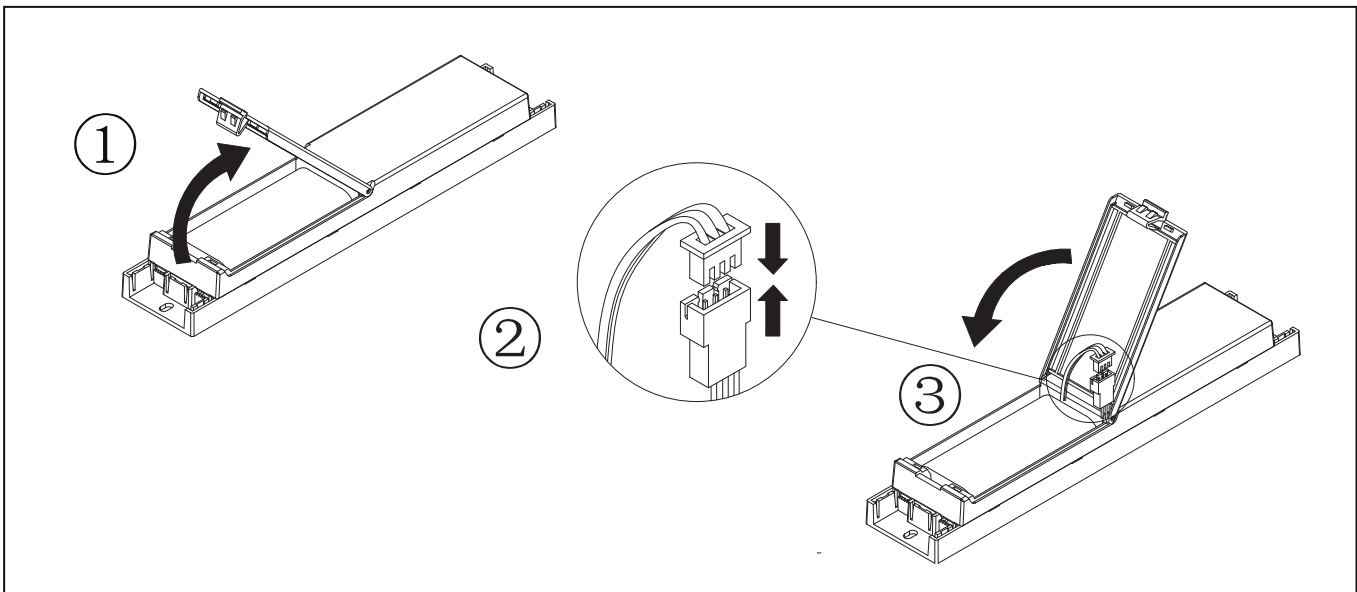

Ansell Electrical Products
 Unit 6B, Stonecross Industrial Park,
 Yew Tree Way,
 Warrington,
 WA3 3JD

Ansell (Sales & Distribution)
 Unit 2, M2 Business Park,
 Duncrue Street,
 Belfast,
 BT3 9AQ

Ansell (Sales & Distribution) Republic of Ireland Limited
 Unit G1, Block G,
 Calmount Park, Ballymount
 Dublin 12,
 D12 TH56

www.ansell-lighting.com

Warrington Tel: +44 (0)1942 433333



Belfast Tel: +44 (0)2890 773750

International Tel: +44 (0)1942 433343

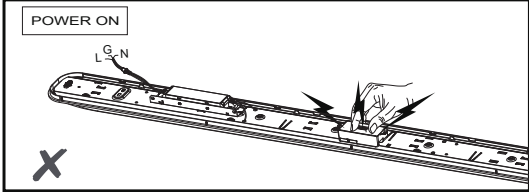
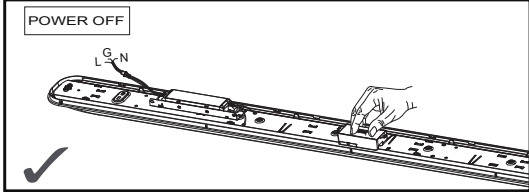
Spain Tel: 00 34 938 005642

1 **POWER ON**  **POWER OFF** 

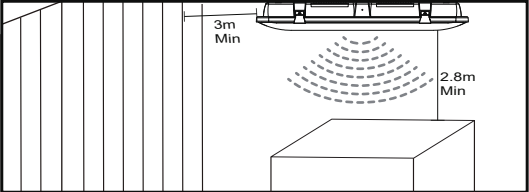
Please turn off the power before installing, wiring, changing the setting of the DIP switch.

2  

This lamp is built in microwave sensor, with different reflection in different space. Avoid getting close to large reflectors, such as metal, glass, wall etc., otherwise false trigger may be occurred.

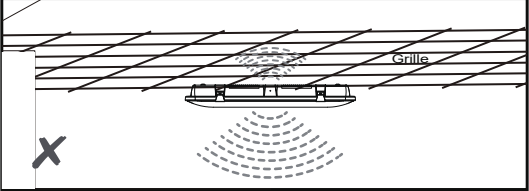
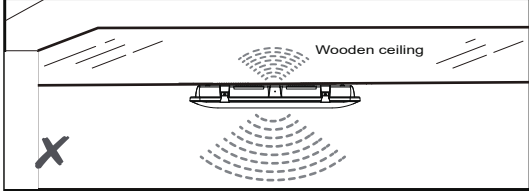
3  

Avoid installing the lamp on grille, wooden and other non-metal ceiling, microwave could pass through and cause false trigger.

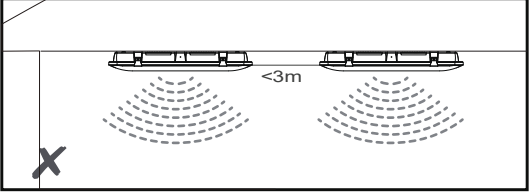
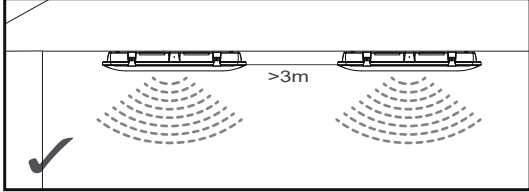
4  

The distance between any lamps should be 3m at least to avoid interfering each other.

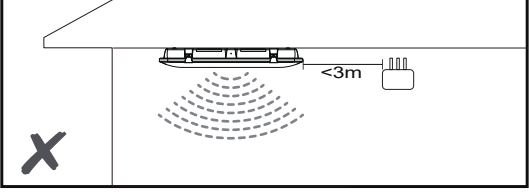
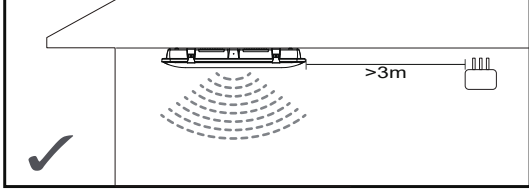
5  

Stay away from wireless devices, such as Wi-Fi router, signal amplifier etc.

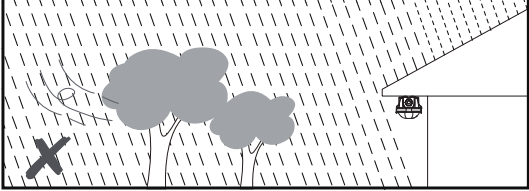
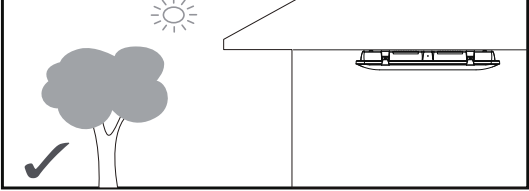
6  

Note: There is a higher risk of false triggering when it is windy or rainy when using outdoors. Installation should be as far away as possible from the presence of detected movement of objects.

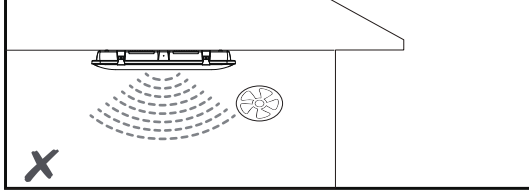
7 

Avoid installing around any motion signal, such as air vents, electric fan, running equipment etc..

Ansell Electrical Products
Unit 6B, Stonecross Industrial Park,
Yew Tree Way,
Warrington,
WA3 3JD

Ansell (Sales & Distribution)
Unit 2, M2 Business Park,
Duncrue Street,
Belfast,
BT3 9AQ

Ansell (Sales & Distribution) Republic of Ireland Limited
Unit G1, Block G,
Calmount Park, Ballymount
Dublin 12,
D12 TH56

www.ansell-lighting.com

MWS Clip-Instruction

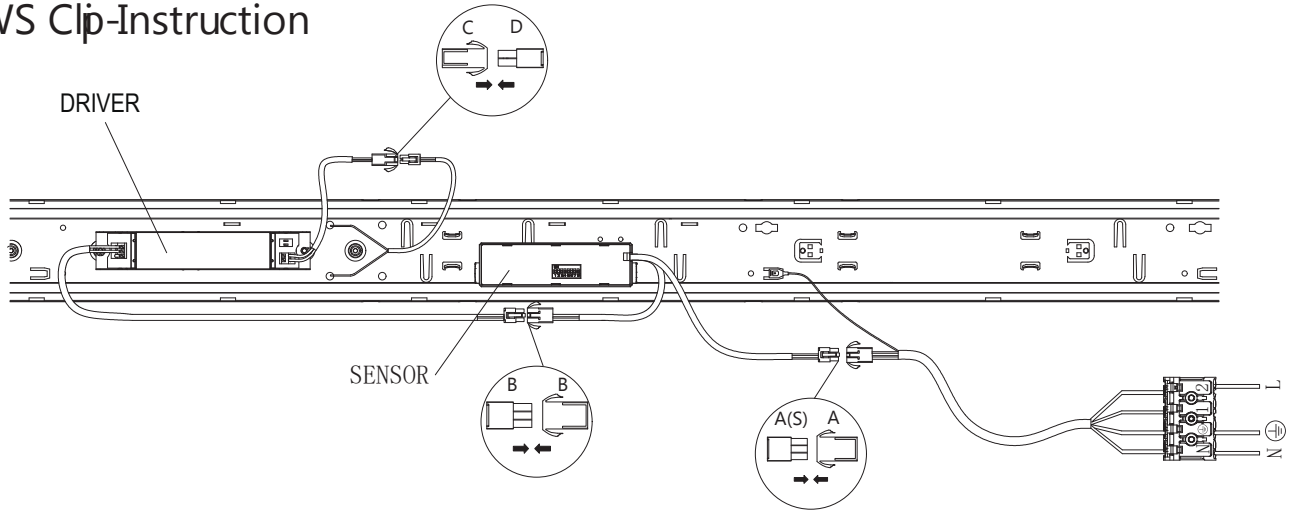

Emergency Clip-In Instruction

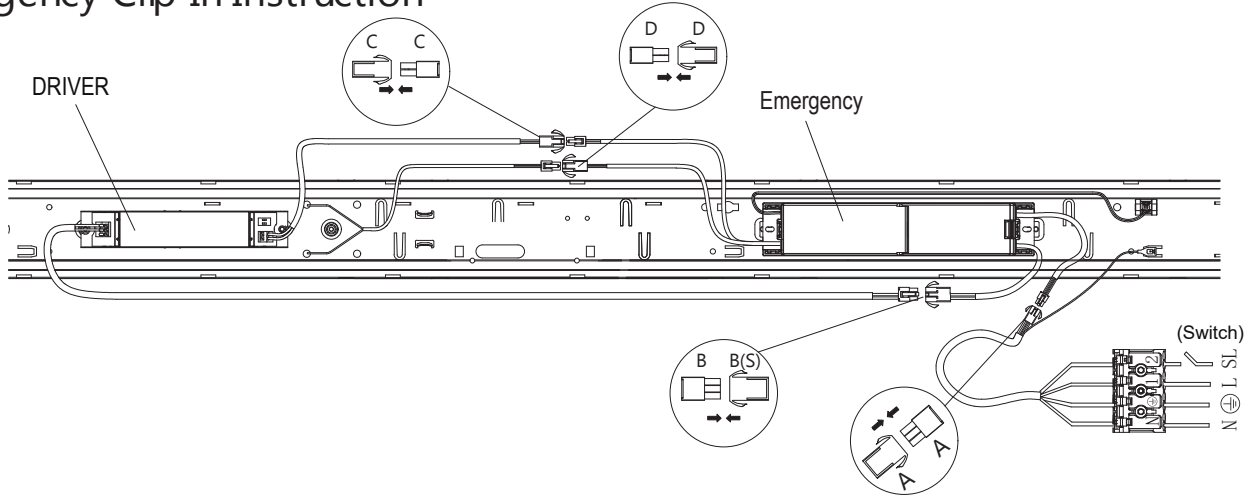

MWS and Emergency Clip-Instruction

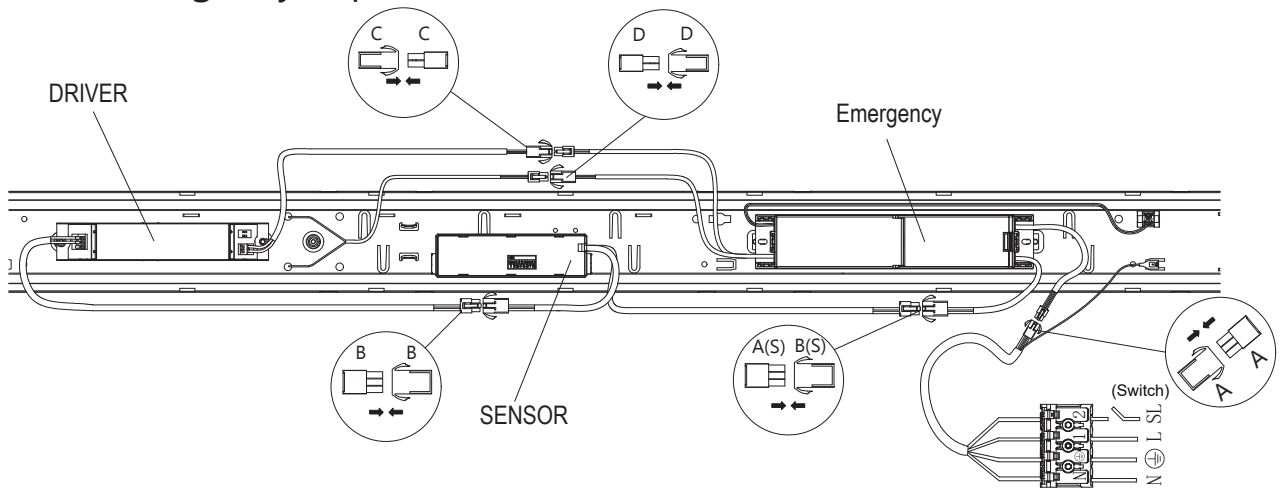

Ansell Electrical Products
Unit 6B, Stonecross Industrial
Park,
Yew Tree Way,
Warrington,
WA3 3JD

Ansell (Sales & Distribution)
Unit 2, M2 Business Park,
Duncrue Street,
Belfast,
BT3 9AQ

Ansell (Sales & Distribution) Republic of Ireland Limited
Unit G1, Block G,
Calmount Park, Ballymount
Dublin 12,
D12 TH56

www.ansell-lighting.com