

Dorcas Rim Electric Releases with Mortice Faceplates for Timber Doors



A range of cost effective Dorcas electric releases for use with 12V Access Control and Door Entry Systems.

The releases are suitable for low to medium traffic applications and all come complete with a mortice faceplate.

Features & Benefits

- Fail locked or unlocked versions are available
- Rim releases suitable for rim night latches fitted on inward opening doors
- If used with mortice faceplate suitable for inward or outward opening doors
- Suits latches with 12mm maximum throw
- Jaw strengths up to 880lbf (362kgf/256N)
- Operating voltage 12V AC or 12V DC
- Grey powder coated finish

Dorcas Rim Electric Releases with Mortice Faceplates for Timber Doors

Stock Code	Description	Voltage	Fail Locked/Unlocked	Suitable with Securefast Lock
ADCN203+S	Rim/Mortice	12V AC/DC	Fail Locked	SEU511 / SEU512 / SEU513 / SEU514 / Rim Nightlatch
ADCN203+S/FLEX	Rim/Mortice with Adjustable Jaw	12V AC/DC	Fail Locked	
ADCN203-412+S	Rim/Mortice, Continuously Rated	12V DC	Fail Locked	
ADCN203-412+SFLX	Rim/Mortice, Adjustable Jaw, Continuously Rated	12V DC	Fail Locked	
ADCN203-512+S	Rim/Mortice	12V DC	Fail Unlocked	
ADCN203-512+SFLX	Rim/Mortice with Adjustable Jaw	12V DC	Fail Unlocked	

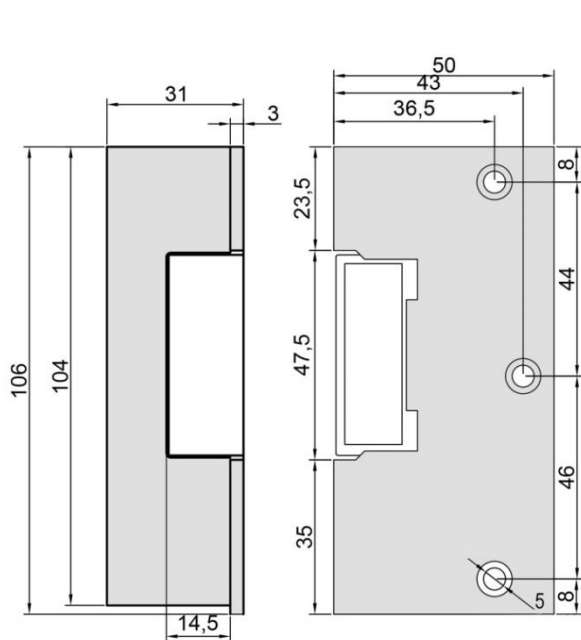

Rim type dimensions

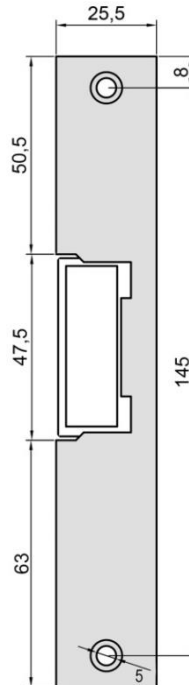

Mortice Faceplate dimensions

For further information contact:

Securefast plc
 6, The Cedars Business Centre
 Avon Road, Cannock
 Staffordshire
 WS11 1QJ



Call > +44 (0) 1704 502 801

Email > sales@securefast.co.uk

Visit > www.securefast.co.uk